

VIEW OUR NEW PRODUCT SPEC SHEETS ON OUR WEBSITE



BRITISH BUILT FOR PURPOSE



**PARRY**  
Stainless Steel Products

British Built for Purpose.

Quality stainless steel equipment and fabrications

FURNITURE AND FABRICATIONS CATALOGUE 2020





# Welcome to Parry

Parry is one of the UK's foremost manufacturers of high-quality Stainless Steel Fabricated Products with a 40-year heritage rooted in British craftsmanship.

At Parry, quality and service are second nature. Striving to exceed our customers' expectations is not just our motto; it's the very heartbeat of our business. Our commitment to our customers is reflected in the **Parry 4E Standard Inspection Body** stating that all our products are:



**Easy to use**



**Easy to maintain**



**Easy to clean**



**Easy to repair**

Our ranges of Stainless Steel Products have been specifically designed with the consumer in mind and are tailored and compliant to your specific industry sector. All our products are 4E Compliant and meet EU & UK regulations, where applicable. The Parry brand stands for quality, reliability and value.

Our British designed products have been created by our expert in-house development team and manufactured to exacting standards using Industry specified grade of European stainless steel and holding relevant EU & UK certification for all product.

ISO9001 certification and continual investment in the training and development of our highly skilled, artisan workforce means that our clients have genuine peace of mind that they are buying hand crafted, quality products supported by five-star customer service. All Parry products meet EU regulations for their respective sector.

We are LEAN manufacturers, minimising waste, maximising productivity. We are proud to run an operation that is committed to minimising our impact on the environment.

Our equipment and furniture are manufactured in our 45,000 sq ft manufacturing facility in Draycott, Derbyshire in England's industrial heartland. Products are made to order if not available in our stocked items which means you can choose from 600 products, offering over 3,500 variants, with short lead times to suit your specific needs. That means you get exactly what you need when you need it.

Our product information can be found here, in our brochure or on our website [www.parry.co.uk](http://www.parry.co.uk).

You have my personal commitment that Parry will exceed your expectations. Should you have any questions please contact your distributor. Alternatively, our customer services team will be happy to help you on **01332 875544**.

**Mark Banton MBA**  
**Managing Director**



# ENVIRONMENTAL POLICY

Parry's management and staff are conscious of the increasing need for environmental protection and consumer's desire for this approach to manufacturing and our carbon footprint as a supplier to the OEM market, Healthcare Market and Public Sector Organisations through our distributor network.













Our environmental policy forms an integral part of the overall business philosophy and our approach to product development. We know that our activities, and those of our employees, have an effect upon the environment and it is, therefore, important to us that we take steps to minimise this impact through positive actions and we continue to have this as a focus through 2020 with our product development team. With substantial investment into renewable energy now completed, we are close to achieving our target of a carbon neutral manufacturing plant.

## Parry's key environmental drivers:

- Sourcing and utilising raw materials which make the minimum possible demands on the environment.
- Effective production strategies which maximise efficiency and minimise waste.
- An active waste reduction policy.
- Optimised recycling processes.
- Minimising the volume of waste consigned to landfill.
- Counter-balancing our carbon footprint through the use of solar technology.



## KEY TO PRODUCT ICONS

	ELECTRIC		RESISTANT TO COLD LIQUIDS		BIOHAZARD
	GAS		HEAVY DUTY		MEETS APPROPRIATE BS4068 STANDARDS
	ISO 9001		CE		
	2 YEAR WARRANTY		FLAME RETARDANT		

# Steel Fabrications

Bespoke Fabrications	54-55
Stainless Steel Cladding	56
Canopies	57-59
Warewashing Tables	60-61
Sinks and Taps	62-63
Hand Wash and Janitorial Sinks	64
Mobile Wash Basins	65
Quick Fit Sink	66
Scrub Sinks, Ice Well and Urinal	67
Height Adjustable Table	68
Tables	69-73
Flatpack Table	74
Folding Table	75
Equipment Stands	76
Shelves and Racks	77-83
Flatpack Cupboard	84-85
COSHH Cupboards	86
3 Door Base Cabinets	87
Corner and Drawer Units	88
Wall Cupboards	89
<b>Electrical Range</b>	<b>11</b>
<b>Gas Range</b>	<b>41</b>
<b>Technical Drawings</b>	<b>90-93</b>
<b>Cleaning Advice</b>	<b>94</b>
<b>Healthcare</b>	<b>95</b>
<b>Warranty Policy</b>	<b>102</b>
<b>Returns Policy</b>	<b>103</b>
<b>Terms &amp; Conditions</b>	<b>104</b>



# Bespoke Fabrications

We can manufacture most products within our range to your exact requirements

**For a quote call our Bespoke Fabrication service now on 01332 875544**

**At any point we are producing bespoke products for some of the biggest brand names in the UK.**

We can develop stainless steel products for a range of applications including;

- Bars, from sinks and speed rails behind the bar to servery counters facing your customers,

Whatever size or design you need our bespoke fabrication service can manufacture most products within our range to your exact requirements upon request. We can also manufacture something completely bespoke from scratch for you, working from your drawings or from scratch and doing the design work in-house.

Our artisan craftsmen hand-build our stainless steel products at our site in Derby. We have a constant pipeline of product development in various stages of R&D.

- Bespoke catering units, either static or mobile, heated or chilled,
- Hotel room service heated trolleys,
- Butchery tables, sinks, and cladding,
- Production kitchens, including tables, sinks and trolleys,
- Veterinarian products, Workshops and Garages.





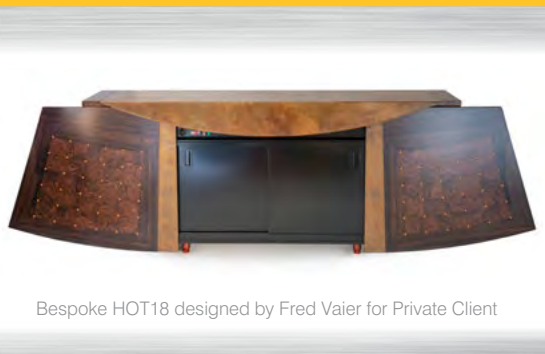

Bespoke HOT18 designed by Fred Vaier for Private Client



**“I expected you to do a good job... but you excelled”**

**“We really have appreciated how quick you guys work to make life easier for us”**





# Stainless Steel Cladding



High quality stainless steel cladding, perfect for a wide range of applications from Parry.

If you are looking for high grade stainless steel cladding we can help! Our range of cladding products are designed to offer you complete flexibility and choice to ensure that whatever your needs are, they're met.

Our off the shelf range covers all of the most popular cladding required sizes that our customers regularly ask for. However, if there is something that you need that's not on the list, not a problem.

Our bespoke service is only a phone call away and ready to make any item at a specific size, just call sales now to discuss your requirements.

Model No.	Description	Price
SSC151000/304	1500x1000mm s/s Sheet - 304	£178
SSC201000/304	2000x1000mm s/s Sheet - 304	£217
SSC251000/304	2500x1000mm s/s Sheet - 304	£245
SSC181250/304	1800x1250mm s/s Sheet - 304	£224
SSC201250/304	2500x1250mm s/s Sheet - 304	£328
SSC151000/430	1500x1000mm s/s Sheet - 430	£139
SSC201000/430	2000x1000mm s/s Sheet - 430	£170
SSC251000/430	2500x1000mm s/s Sheet - 430	£202
SSC181250/430	1800x1250mm s/s Sheet - 430	£172
SSC201250/430	2500x1250mm s/s Sheet - 430	£244
CORNERCAPSINT	50x50x2500 s/s Corner Cap Internal	£41
CORNERCAPSEXT	50x50x2500 s/s Corner Cap External	£41



## Cladding Delivery

Due to our cladding being delivered on pallets, any cladding above 1000mm wide will have to be delivered in 2 pieces, to allow it to fit onto the pallet.

Due to the delivery requirements, all cladding has an additional delivery charge of £70 per pallet.

## Bespoke Service

This item can be made to order. Whatever size you need our fabrication team can build it to your exact size requirements. **Call 01332 875544 for a quote now.**

# Condensate Canopies / Steam Hoods

Moisture control for your catering environment

Kitchens, as a rule are areas where moisture is part of the working day. Just cooking food releases moisture into the environment, making the air more humid. When you introduce ware washing solutions into a catering environment the moisture levels increase dramatically, and in a kitchen that's not always good for the food or the staff.

Condensate canopies (also known as steam hoods) are designed to manage and expel excess moisture produced by high steam output equipment like dishwashers, combination ovens and atmospheric steamers. Fitted above equipment, these canopies allow steam laden air to be safely captured.

They are fitted with a sloped condensation plate which, on contact with steam turns it into water and then directs it into a drain off, keeping it out of the air and reducing overall environmental humidity.

The result is less humidity, drier surfaces and a safer, more comfortable working environment.



## Condensate Canopy - Steam Hood

- Ideal for use with dishwashers and combination ovens
- Manufactured from high quality stainless steel
- Drain tap to rear included
- Easy clean design
- Heavy duty construction
- Bespoke dimensions available on request

Model No.	Dims (WxDxH)mm	Price With Baffle
CON1000	1000 x 1100 x 500	£1075
CON1200	1200 x 1100 x 500	£1105
CON1700	1700 x 1100 x 500	£1751
CON2100	2100 x 1100 x 500	£2088





# Canopies

## Step One Choose your canopy...

### The Snack Canopy



The perfect canopy for small scale catering requirements, like cafés and small restaurants.

- Ideal for low ceiling applications
- Baffle filters
- Manufactured from high quality stainless steel
- Fat collection drawer
- Easy clean design
- Heavy duty construction
- Rear or top exhaust as standard

### The General Canopy



Designed to meet the requirements of small to medium size catering environments.

- Baffle filters
- Manufactured from high quality stainless steel
- Fat collection drawer
- Easy clean design
- Heavy duty construction
- Rear or top exhaust as standard

### The Titan Canopy



A heavy duty solution for all large scale catering environments, like large hotels and hospitals.

- Baffle filters
- Manufactured from high quality stainless steel
- Fat collection drawer
- Easy clean design
- Heavy duty construction
- Rear or top exhaust as standard

Images for illustrative purposes only - products may vary

1000/1200/1500/1800/2100/2400

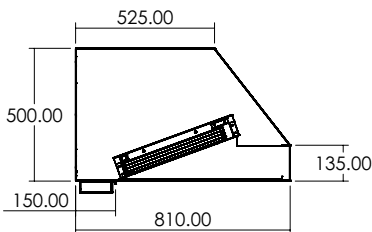

1000/1200/1500/1800/2100/2400

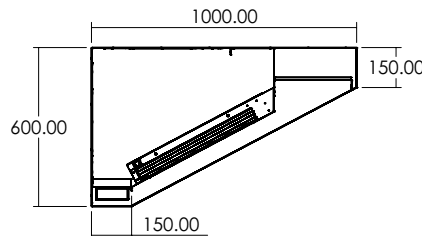

1200/1500/1800/2100/2400

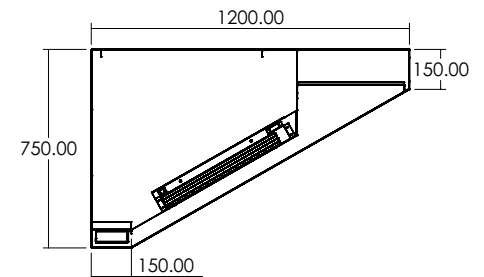

	Model No.	(WxDxH)mm	Canopy
<b>SNACK</b>	ST1050	1000 x 810 x 500	<b>£1025</b>
	ST1250	1200 x 810 x 500	<b>£1103</b>
	ST1550	1500 x 810 x 500	<b>£1250</b>
	ST1850	1800 x 810 x 500	<b>£1385</b>
	ST2150	2100 x 810 x 500	<b>£1723</b>
	ST2450	2400 x 810 x 500	<b>£1882</b>

	Model No.	(WxDxH)mm	Canopy
<b>GENERAL</b>	GT1010	1000 x 1000 x 600	<b>£1091</b>
	GT1210	1200 x 1000 x 600	<b>£1182</b>
	GT1510	1500 x 1000 x 600	<b>£1329</b>
	GT1810	1800 x 1000 x 600	<b>£1430</b>
	GT2110	2100 x 1000 x 600	<b>£1857</b>
	GT2410	2400 x 1000 x 600	<b>£2090</b>

	Model No.	(WxDxH)mm	Canopy
<b>TITAN</b>	TT1275	1200 x 1200 x 750	<b>£1263</b>
	TT1575	1500 x 1200 x 750	<b>£1415</b>
	TT1875	1800 x 1200 x 750	<b>£1544</b>
	TT2175	2100 x 1200 x 750	<b>£1926</b>
	TT2475	2400 x 1200 x 750	<b>£2127</b>

## Step Two Specify your options...

### External Fan Pack



Image for illustrative purposes only - product may vary

Everything you need in one pack for external venting for our canopies.

- Axair brand variable speed controller unit
- High quality fan unit
- Flanges

#### Canopy with external fan

	Model No.	(WxDxH)mm	Canopy
<b>SNACK</b>	ST1050-EF	1000 x 810 x 500	<b>£2017</b>
	ST1250-EF	1200 x 810 x 500	<b>£2096</b>
	ST1550-EF	1500 x 810 x 500	<b>£2243</b>
	ST1850-EF	1800 x 810 x 500	<b>£2378</b>
	ST2150-EF	2100 x 810 x 500	<b>£2770</b>
	ST2450-EF	2400 x 810 x 500	<b>£2929</b>
<b>GENERAL</b>	GT1010-EF	1000 x 1000 x 600	<b>£2083</b>
	GT1210-EF	1200 x 1000 x 600	<b>£2174</b>
	GT1510-EF	1500 x 1000 x 600	<b>£2322</b>
	GT1810-EF	1800 x 1000 x 600	<b>£2423</b>
	GT2110-EF	2100 x 1000 x 600	<b>£2937</b>
	GT2410-EF	2400 x 1000 x 600	<b>£3137</b>
<b>TITAN</b>	TT1275-EF	1200 x 1200 x 750	<b>£2256</b>
	TT1575-EF	1500 x 1200 x 750	<b>£2408</b>
	TT1875-EF	1800 x 1200 x 750	<b>£2591</b>
	TT2175-EF	2100 x 1200 x 750	<b>£2973</b>
	TT2475-EF	2400 x 1200 x 750	<b>£3174</b>

### Internal Fan Pack



Image for illustrative purposes only - product may vary

By choosing the internal fan pack, the fan system is easily installed inside your chosen canopy.

## Accessories

Interlock **£888**

#### Canopy with internal fan

	Model No.	(WxDxH)mm	Canopy
<b>SNACK</b>	ST1050-IF	1000 x 810 x 500	<b>£1833</b>
	ST1250-IF	1200 x 810 x 500	<b>£1909</b>
	ST1550-IF	1500 x 810 x 500	<b>£2136</b>
	ST1850-IF	1800 x 810 x 500	<b>£2449</b>
	ST2150-IF	2100 x 810 x 500	<b>£2799</b>
	ST2450-IF	2400 x 810 x 500	<b>£2958</b>
<b>GENERAL</b>	GT1010-IF	1000 x 1000 x 600	<b>£1917</b>
	GT1210-IF	1200 x 1000 x 600	<b>£1987</b>
	GT1510-IF	1500 x 1000 x 600	<b>£2214</b>
	GT1810-IF	1800 x 1000 x 600	<b>£2314</b>
	GT2110-IF	2100 x 1000 x 600	<b>£2932</b>
	GT2410-IF	2400 x 1000 x 600	<b>£3163</b>
<b>TITAN</b>	TT1275-IF	1200 x 1200 x 750	<b>£2149</b>
	TT1575-IF	1500 x 1200 x 750	<b>£2300</b>
	TT1875-IF	1800 x 1200 x 750	<b>£2507</b>
	TT2175-IF	2100 x 1200 x 750	<b>£3000</b>
	TT2475-IF	2400 x 1200 x 750	<b>£3200</b>

Gas interlock available upon request - **£888**

## What is a Gas Interlock System?

In short - it is a system that ensures the safety of your kitchen and staff by monitoring the air flow in your catering environment and can detect possibly dangerous situations where potential hazards may occur.

For more information about this system and its benefits call sales now or visit: [www.blackteknigas.com/media/BTandEC\\_Provengas\\_Brochure\\_v5.pdf](http://www.blackteknigas.com/media/BTandEC_Provengas_Brochure_v5.pdf)



# Warewashing Tables

The easiest way to get the perfect warewashing tables.

## Cleans Tabling

Made from high quality stainless steel, our cleans tabling is available in a wide selection of standard, off-the-shelf lengths and can be specified with shelving and storage racks. If you need one at a specific length our bespoke team is always on hand.



## Dirty Tables

Just like our Cleans tables, all of our dirty tables are made from high quality stainless steel and can be specified with a wide range of bowl, tap and accessory options to ensure you get the perfect table for your needs.

Image for illustrative purposes only - product may vary

## Cleans Tables

Step One → Choose Cleans Table...

Model No.	(WxDxH)mm	Price
DWC700	700x700x880mm	<b>£443</b>
DWC1000	1000x700x880mm	<b>£536</b>
DWC1200	1200x700x880mm	<b>£602</b>
DWC1500	1500x700x880mm	<b>£636</b>
DWC1800	1800x700x880mm	<b>£702</b>

Step Two → Optional Extras...

Model No.	Description	Price
DWSHELF	700mm - 1200mm Shelf For Dishwash Tabling	<b>£145</b>
DWSHELF1500	1500mm + Shelf For Dishwash Tabling	<b>£172</b>
DWRACK3	3 Rack Storage For Dishwash Tabling	<b>£67</b>

## Custom made tabling for ANY brand or model.

Whatever make or model of ware washing equipment you have, we can make tabling to fit both its and your needs perfectly. All we require is the profile for the entry of the equipment and we do the rest. Simple, straight forward and hassle free.

For more information about bespoke tabling call sales now.

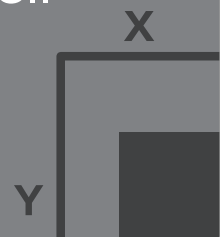

# Dirtyes Tables

## Step One Choose Dirtyes Table...

Model No.	(WxDxH)mm	Price
DWD1000	1000x700x880mm	<b>£536</b>
DWD1200	1200x700x880mm	<b>£602</b>
DWD1500	1500x700x880mm	<b>£636</b>
DWD1800	1800x700x880mm	<b>£702</b>

## Step Three Choose Extras...

Model No.	Description	(WxDxH)mm	Price
SCRAP	Scraphole and Ring	-	<b>£103</b>
SBBOWL	Splashback For Behind Bowl	-	<b>£94</b>
SB1500	Splashback	1500mm	<b>£145</b>
SB1800	Splashback	1800mm	<b>£172</b>

## Step Two Choose Bowl size...

Model No.	(WxDxH)mm	Price
BOWL400	400x400x300	<b>£391</b>
BOWL500	500x400x300	<b>£407</b>
BOWL600	610x450x300	<b>£436</b>

## Step Four Choose Taps

Model No.	Description	Price
BASINTAPL	Basin Taps, 12.25mm (1/2"), Set	<b>£45</b>
PILLARTAPL	Pillar Taps, 8mm (1/3"), Set	<b>£50</b>
MIXERTAPL	Mixer Tap With Swivel Spout (1/2")	<b>£263</b>
MONOTWIN	Mono Block Taps (1/2")	<b>£143</b>
SPRAYARMDECK	Deck Pre-rinse Spray Arm	<b>£449</b>
SPRAYARMTFACT	Twin Deck Pre-rinse Spray Arm With Faucet	<b>£599</b>
SPRAYARMDFACT	Deck Pre-rinse Spray Arm With Faucet	<b>£608</b>
SPRAYARMSINGP	Deck Single Feed Pre-rinse Spray Arm	<b>£369</b>
SPRAYARMTWIN/DP	Deck Twin Feed Pre-rinse Spray Arm	<b>£309</b>

## Taps



BASINTAPL



PILLARTAPL



SPRAYARMDECK



SPRAYARMSINGP



SPRAYARMTWIN/DP



SPRAYARMTFACT



MONOTWIN



MIXERTAPL

### Put the table you need together. Simple!

At Parry we always try and make choosing the right equipment to fit your needs as easy as possible - this goes for our cleans and dirtyes tables too.

### Configuration Example

DWD1000 £536 (table base unit). Then add a BOWL400 £391 (400x400x300mm bowl unit) and then add an SBBOWL £94 (splashback for behind bowl) and then add a SPRAYARMSINGP £329 (deck single feed pre-rinse spray arm deck).

**Total price £1,350**



# Sinks and Taps

The easiest way to get a fully assembled sink.

## Stainless Steel Assembled Sinks

- All sinks supplied with 11" stainless steel upright plug as standard - deluxe version available with metal shroud at £47 list
- Complete with undershelf and standard frame
- All unit tops manufactured from high grade stainless steel
- Voids available on request

**Please Note: Sinks are NOT supplied with taps - please specify when ordering. If you require any other configuration please ask.**



SINK1060L

Image for illustrative purposes only - product may vary.  
See page 92 for technical drawing



SINK1860DBDD

Image for illustrative purposes only - product may vary.



SINK0860SBND

Image for illustrative purposes only - product may vary.



SINKD1660SBDD

Image for illustrative purposes only - product may vary.

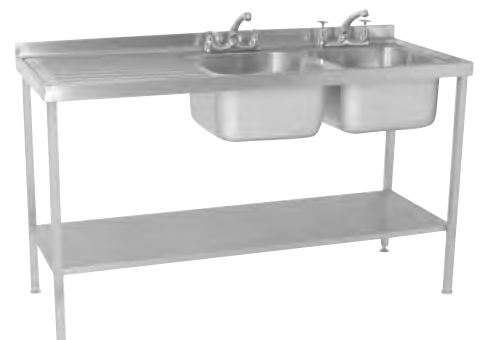

SINK1870DBLHD

Image for illustrative purposes only - product may vary.

## Step One

## Choose Your Sink Unit...

Model No.	Description	Full Unit Dimensions	Bowl Dimensions	Full Unit Price	Sink Top Price
SINK0860SBND	Single Bowl No Drainer	800x600x900	500x400x300	£687	£375
SINK0870SBND	Single Bowl No Drainer	800x700x900	500x600x300	£698	£375
SINK1060L	Single Bowl Single Drainer Left	1000x600x900	400x400x300	£703	£386
SINK1060R	Single Bowl Single Drainer Right	1000x600x900	400x400x300	£703	£386
SINK1070L	Single Bowl Single Drainer Left	1000x700x900	400x400x300	£714	£397
SINK1070R	Single Bowl Single Drainer Right	1000x700x900	400x400x300	£714	£397
SINK1260L	Single Bowl Single Drainer Left	1200x600x900	400x400x300	£757	£407
SINK1260R	Single Bowl Single Drainer Right	1200x600x900	400x400x300	£757	£407
SINK1260SBDD	Single Bowl Double Drainer	1200x600x900	400x400x300	£779	£407
SINK1270L	Single Bowl Single Drainer Left	1200x700x900	500x500x300	£805	£408
SINK1270R	Single Bowl Single Drainer Right	1200x700x900	500x500x300	£805	£408
SINK1270SBDD	Single Bowl Double Drainer	1200x700x900	500x500x300	£828	£408
SINK1470L	Single Bowl Single Drainer Left	1400x700x900	500x500x300	£936	£460
SINK1470R	Single Bowl Single Drainer Right	1400x700x900	500x500x300	£936	£460
SINKD1560BDL	Double Bowl Single Drainer Left	1500x600x900	400x400x300	£1184	£518
SINKD1560DBR	Double Bowl Single Drainer Right	1500x600x900	400x400x300	£1184	£518
SINK1570DBL	Double Bowl Single Drainer Left	1500x700x900	400x400x300	£1237	£545
SINK1570DBR	Double Bowl Single Drainer Right	1500x700x900	400x400x300	£1237	£545
SINK1860DBDD	Double Bowl Double Drainer Sink	1800x600x900	400x400x300	£1364	£666
SINKD1870DBL	Double Bowl Single Drainer Left	1800x700x900	500x500x300	£1346	£661
SINKD1870DBR	Double Bowl Single Drainer Right	1800x700x900	500x500x300	£1346	£661
SINK2460DBDD	Double Bowl Double Drainer Sink	2400x600x900	500x400x300	£1385	£724
SINK2470DBDD	Double Bowl Double Drainer Sink	2400x700x900	600x500x300	£1408	£777

### Flat Pack Options

SINK1060LFP	Single Bowl Single Drainer Left	1000x600x900	400x400x300	£641	£386
SINK1060RFP	Single Bowl Single Drainer Right	1000x600x900	400x400x300	£641	£386
SINK1070LFP	Single Bowl Single Drainer Left	1000x700x900	400x400x300	£651	£397
SINK1070RFP	Single Bowl Single Drainer Right	1000x700x900	400x400x300	£651	£397
SINK1260LFP	Single Bowl Single Drainer Left	1200x600x900	400x400x300	£687	£407
SINK1260RFP	Single Bowl Single Drainer Right	1200x600x900	400x400x300	£687	£407
SINK1270LFP	Single Bowl Single Drainer Left	1200x700x900	500x500x300	£739	£408
SINK1270RFP	Single Bowl Single Drainer Right	1200x700x900	500x500x300	£739	£408
SINK1470LFP	Single Bowl Single Drainer Left	1400x700x900	500x500x300	£879	£460
SINK1470RFP	Single Bowl Single Drainer Right	1400x700x900	500x500x300	£879	£460
SINK1560DBLFP/RFP	Double Bowl Single Drainer	1500x600x900	400x400x300	£1062	£518
SINK1570DBLFP/RFP	Double Bowl Single Drainer	1500x700x900	500x400x300	£1129	£604
SINK1860DBDDFP	Double Bowl Double Drainer Sink	1800x600x900	400x400x300	£1230	£661
SINK1870DBDDFP	Double Bowl Double Drainer Sink	1800x700x900	400x400x300	£1307	£721

**Please Note: Other bowl sizes are available on all sinks. Call Sales for more information.**

## Step Two

## Choose Extras...

Model No.	Description	Dimensions	Price
DRAWER1	Single Drawer Unit For Table	-	£158
SD800	Sliding Doors	800mm - 1500mm	£400
SD1600	Sliding Doors	1600mm - 2400mm	£427
DWSHELF	Extra Shelf	700mm - 1200mm	£145
DWSHELF-1500	Extra Shelf	1500mm +	£172
SP800	Side Panels Left Or Right	800mm - 1500mm	£67
SP1600	Side Panels Left Or Right	1600mm - 2100mm	£108
SBBOWL	Splashback For Behind Bowl	-	£94
WASTE	Standard Waste For Sink (Stainless 11")	-	£18
DWASTE	Deluxe Waste For Sink (11" Black With Metal Shroud)	-	£52
FREST	Foot Rest Or Tie Bar	-	£52



BASINTAPL



PILLARTAPL



MONOTWIN



MIXERTAPL

## Step Three

## Choose Taps

Model No.	Description	Price
BASINTAPL	Basin Taps 12.25mm (1/2") Set	£45
PILLARTAPL	Pillar Taps 8mm (1/3") Set	£50
MIXERTAPL	Mixer Tap with Swivel Spout (1/2")	£263
MONOTWIN	Mono Block Taps (1/2")	£143
SPRAYARMDECK	Deck Pre-rinse Spray Arm	£449
SPRAYARMTFACT	Twin Deck Pre-rinse Spray Arm With Faucet	£599
SPRAYARMDFACT	Deck Pre-Rinse Spray Arm Deck With Faucet	£608
SPRAYARMSINGP	Deck Single Feed Pre-Rinse Spray Arm	£369
SPRAYARMTWIN/DP	Deck Twin Feed Pre-Rinse Spray Arm	£309



SPRAYARMDECK



SPRAYARMSINGP



SPRAYARMTWIN/DP



SPRAYARMTFACT



# Hand Wash and Janitorial Sinks

## Stainless Steel Knee Operated Hand Wash Basin

- Manufactured from high quality stainless steel
- Operated by a simple knee push
- Designed to reduce contamination
- Complete with a waste, plug and tap
- Includes 40mm up-stand

Model No.	Dimensions (WxDxH)	Bowl Size	Price
CWBKNEE - Wash Hand Basin	408x380x260mm	430x280x130mm	<b>£343</b>



CWBKNEE

Image for illustrative purposes only - product may vary

## Stainless Steel Mini Hand Wash Sink

- Manufactured from high quality stainless steel
- Complete with a waste and plug
- Includes 20mm up-stand
- Taps included on the CWBMIN/T only

Model No.	Dimensions (WxDxH)	Bowl Size	Price
CWBMIN	300x300x140	270x210x120	<b>103</b>
CWBMIN/T (with taps)	300x300x140	270x210x120	<b>£140</b>



CWBMIN/T

Image for illustrative purposes only - product may vary

## Stainless Steel Square Hand Wash Sinks

- Manufactured from high quality stainless steel
- Square bowl
- Complete with a waste and plug
- Includes 20mm up-stand
- Taps included on the CWBHANDI/T only

Model No.	Dimensions (WxDxH)	Bowl Size	Price
CWBHANDI	265x330x140	240x240x120	<b>£184</b>
CWBHANDI/T (with taps)	265x330x140	240x240x120	<b>£227</b>



CWBHANDI/T

Image for illustrative purposes only - product may vary

## Stainless Steel Janitorial Sinks

- Manufactured from high quality stainless steel
- Complete with a waste, plug and tap

Model No.	Dimensions (WxDxH)	Bowl Size	Price
JANUNIT	500x700x930mm	lower bowl: 432x356x180mm upper bowl: 229x356x180	<b>£581</b>



JANUNIT

Image for illustrative purposes only - product may vary

# Mobile Wash Basins

## MWBT and MWBTD Single Bowl Mobile Wash Hand Basins

### FEATURES

- Mobile sink unit
- 15 litres capacity
- 3kW and supplied with a 13amp plug (600W element available)
- Easy removable waste water receptacle
- Water temperature maintained at 42 degrees
- Foot operated water pump
- Rear wheels and handle for easy manoeuvring
- Pressure cut out prevents hot water tank from boiling dry
- Manufactured from high quality stainless steel
- Accessories available



MWBT



MWBTD



MWBT  
Shown with  
accessories attached



## Accessories

Choose your accessories for your MWBT or MWBTD

- Splashback **£81**
- Paper towel holder **£72**
- Soap dispenser holder **£50**

Model No.	Dimensions (WxDxH)	Rating	Weight	Price
MWBT - Single Bowl Mobile Wash Hand Basin	450x600x900mm (with splashback 1350h)	3.0kW	20kg	<b>£1053</b>
MWBTD - Single Bowl Mobile Wash Hand Basin with door	450x600x900mm (with splashback 1350h)	3.0kW	20kg	<b>£90A</b>

**PLEASE NOTE:** Fabrication prices are inclusive of carriage charges with the exception of deliveries to the Scottish Highlands and Islands which are price on application. The other exception being stainless steel cladding (see page 104 for details).



# Quick Fit Sink

## QFSINK - Quick Fit Heated Sink

- Any size from 1200mm wide to 1800mm wide
- Mixer taps included
- All hot and cold pipework factory fitted
- Drainage left or right hand – please specify at time of order
- Quick fit unit using a domestic water pipe
- Water heater supplied fits easily to a 13 amp plug included
- Adjustable feet
- Bottom shelf for storage
- Manufactured from high quality stainless steel
- Connects to a 1 ¼" diameter drain system
- Easily installed so can be transported elsewhere with ease
- Fully clad option available on request
- Bespoke sizes available on request



Please Note: Sinks are NOT supplied with taps - please specify when ordering.

Model No.	Dimensions (WxDxH)	Rating	Price
QFSINK1260L10L - Quick Fit Sink 1200 x 600 Left Hand Drainer 10L Boiler	1200x600x900mm	3.0kW	£1971
QFSINK1260R10L - Quick Fit Sink 1200 x 600 Right Hand Drainer 10L Boiler	1200x600x900mm	3.0kW	£1971
QFSINK1470L10L - Quick Fit Sink 1400 x 700 Left Hand Drainer 10L Boiler	1400x700x900mm	3.0kW	£2288
QFSINK1470R10L - Quick Fit Sink 1400 x 700 Right Hand Drainer 10L Boiler	1400x700x900mm	3.0kW	£2288
QFSINK1870L30L - Quick Fit Sink 1800 x 700 Double Bowl Left Hand Drainer 30L Boiler	1800x700x900mm	3.0kW	£5602
QFSINK1870R30L - Quick Fit Sink 1800 x 700 Double Bowl Right Hand Drainer 30L Boiler	1800x700x900mm	3.0kW	£5602

## Stainless Steel Utility Sink

- Manufactured from high quality stainless steel
- Available in a range of sizes
- Splash back available
- Taps can be fitted, either wall mounted or top mounted - please specify at time of ordering

Please Note: Sinks are NOT supplied with taps - please specify when ordering.

Model No.	(WxDxH)	Price
USINK600 - Stainless Steel Utility Sink	600x700x1265mm	£1039
USINK1200 - Stainless Steel Utility Sink	1200x700x1265mm	£1494



Spray Decks



Taps



USINK600

Image for illustrative purposes only - product may vary.

# Scrub Sinks, Ice Wells and Urinal

## Stainless Steel Scrub Sink

- Medical grade stainless steel
- HTM64 compliant
- Drain to right or left - specify when ordering (waste outlet on right unless specified)
- Wipe clean stainless steel
- Available in a range of sizes



SCRUB800

Image for illustrative purposes only - product may vary.



SCRUB800U

Height including box section support is 754mm. Image for illustrative purposes only - product may vary.

**Please Note: Sinks are NOT supplied with taps - please specify when ordering.**

Model No.	(WxDxH)	Price
SCRUB800 - Stainless Steel Scrub Sink	800x400x370mm	£984
SCRUB1000 - Stainless Steel Scrub Sink	1000x400x370mm	£1084
SCRUB1200 - Stainless Steel Scrub Sink	1200x400x370mm	£1084
SCRUB1500 - Stainless Steel Scrub Sink	1500x400x370mm	£1184
SCRUB1800 - Stainless Steel Scrub Sink	1800x400x370mm	£1184
SCRUB2100 - Stainless Steel Scrub Sink	2100x400x370mm	£1284
SCRUB2400 - Stainless Steel Scrub Sink	2400x400x370mm	£1284

Model No.	(WxDxH)	Price
SCRUB800U - Stainless Steel Scrub Sink with Upstand	800x400x504mm	£984
SCRUB1000U - Stainless Steel Scrub Sink with Upstand	1000x400x504mm	£1084
SCRUB1200U - Stainless Steel Scrub Sink with Upstand	1200x400x504mm	£1084
SCRUB1500U - Stainless Steel Scrub Sink with Upstand	1500x400x504mm	£1184
SCRUB1800U - Stainless Steel Scrub Sink with Upstand	1800x400x504mm	£1184
SCRUB2100U - Stainless Steel Scrub Sink with Upstand	2100x400x504mm	£1284
SCRUB2400U - Stainless Steel Scrub Sink with Upstand	2400x400x504mm	£1284



## Stainless Steel Ice Well

- Manufactured from high quality stainless steel
- 38L capacity
- Space for 3 x 1/9 GN pans along the back cut out section
- Also available in a range of bespoke sizes

Model No.	(WxDxH)mm	Price
ICEWELL - Stainless Steel Ice Well	700x490x320mm	£1052



SR600

Image for illustrative purposes only - product may vary

## Stainless Steel Speed Rails

- Manufactured from high quality stainless steel
- Pre drilled mounting holes
- Wall or unit mounting

Model No.	(WxDxH)mm	Price
SR600 - Stainless Steel Speed Rail	610x100x150mm	£163
SR750 - Stainless Steel Speed Rail	760x100x150mm	£169
SR900 - Stainless Steel Speed Rail	910x100x150mm	£176
SR1200 - Stainless Steel Speed Rail	1210x100x150mm	£182

## Stainless Steel Urinal

- Manufactured from high quality stainless steel
- Wall hung
- Drain to right or left - specify when ordering (waste outlet on right unless specified)
- Available in a range of sizes
- Wipe clean stainless steel with attractive brushed finish

**Drain plug to be specified on ordering - left or right side position**



URN1800

Image for illustrative purposes only - product may vary.

Model No.	Dimensions (WxDxH)mm	Price
URN1800 - Stainless Steel Urinal	1800x280x630mm	£742
URN2400 - Stainless Steel Urinal	2400x280x630mm	£1069



# Height Adjustable Table

## Stainless Steel Height Adjustable Table

- High grade stainless steel work surface
- Robust design
- Operating load up to 200kg
- Height adjustable, from 780mm to 1280mm
- Designed to eliminate back pain and potential back injuries
- Static or mobile options
- Steerable castors (2 lockable)
- Tailor made on request
- High quality electric motor
- Height adjustable whilst under load
- Also available as a sink unit or a desk with cladding and integral draw unit
- Also available with a gantry and/or undershelves as shown
- Also available without castors



MODEL	(WxDxH)mm	Power (kW)	£ Price
ADJTAB10750EF	1000x750x780 to 1280	0.5kW	<b>£2456</b>
ADJTAB15750EF	1500x750x780 to 1280	0.5kW	<b>£2648</b>



DOWN - 780mm



UP - 1280mm



Control panel

Other sizes are available.

Call Sales on **01332 875544** to talk to our fabrication team.

## Stainless Steel Tables with One Undershef

- Tops manufactured from high grade 304 stainless steel
- Undershelves manufactured from 430 grade stainless steel
- Wall benches have a rear upstand
- Legs built from 30mm box section
- Welded frame
- Larger sizes available

£POA



## Optional Extras

- Special cut outs (specify location) to fit round pipe and pillars **£169**
- Fitted standard rubber scrap ring **£97**
- Standard side panels left or right **£102**
- Factory fitted sliding doors per metre **£367**
- Extra strengthening per metre **£44**
- Extra upstand (specify left or right hand) per table **£56**
- Drawers for table - single drawer 390 x 550 x 115mm **£225**
- Special chamfers **£131**
- Castors 50mm **£79**
- Castors 75mm **£100**
- Castors 100mm **£143**

Images for illustrative purposes only - product may vary.  
Technical Drawing on page 91

## Valance Options

- Up to 1200x300mm stainless steel valance **£66**
- Up to 1500x300mm stainless steel valance **£76**
- Up to 1800x300mm stainless steel valance **£103**

600mm	(WxDxH)mm	Centre	Wall
TAB06600	600 x 600 x 900	£356	£369
TAB09600	900 x 600 x 900	£388	£400
TAB12600	1200 x 600 x 900	£458	£467
TAB15600	1500 x 600 x 900	£491	£503
TAB18600	1800 x 600 x 900	£517	£531
TAB21600	2100 x 600 x 900	£915	£946
TAB24600	2400 x 600 x 900	£957	£989

700mm	(WxDxH)mm	Centre	Wall
TAB06700	600 x 700 x 900	£381	£393
TAB09700	900 x 700 x 900	£419	£456
TAB12700	1200 x 700 x 900	£529	£538
TAB15700	1500 x 700 x 900	£564	£571
TAB18700	1800 x 700 x 900	£586	£610
TAB21700	2100 x 700 x 900	£946	£978
TAB24700	2400 x 700 x 900	£989	£1020

Other sizes are available.

Call Sales on **01332 875544** to talk to our fabrication team.

# Tables

## Stainless Steel Low Table

- Low tables specially designed giving a standard price for various height work tables or platforms for mounting fryers, griddles and many other appliances.
- Manufactured from high grade stainless steel
- Available at 500mm high at the same price
- Legs built from 30mm box section
- Welded frame
- Larger sizes available

£POA

## Optional Extras

- Special cut outs (specify location) to fit round pipe and pillars **£169**
- Fitted standard rubber scrap ring **£97**
- Standard side panels left or right **£102**
- Factory fitted sliding doors per metre **£367**
- Extra strengthening per metre **£44**
- Extra upstand (specify left or right hand) per table **£56**
- Drawers for table single drawer 390 x 550 x 115mm **£225**
- Special chamfers **£131**
- Castors 50mm **£79**
- Castors 75mm **£100**
- Castors 100mm **£143**

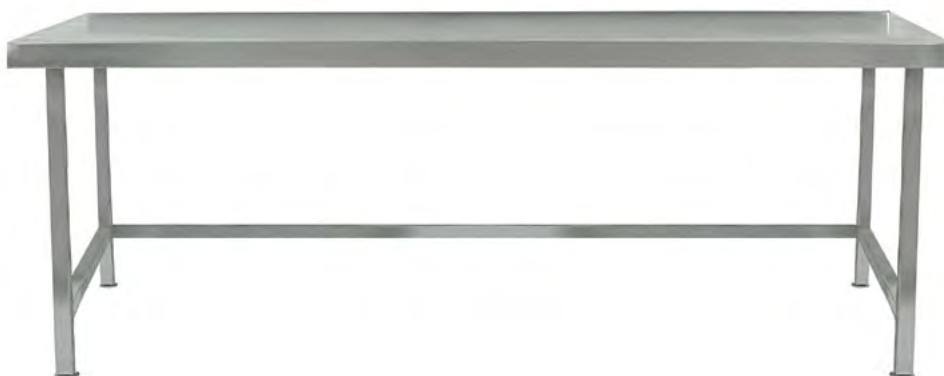

Image for illustrative purposes only - product may vary.  
Technical Drawing on page 90

## Valance Options

- Up to 1200x300mm stainless steel valance **£66**
- Up to 1500x300mm stainless steel valance **£76**
- Up to 1800x300mm stainless steel valance **£103**

Please note: The tie bars are attached by zip ties for transportation purposes. Once in situ these need to be removed.

600mm	(WxDxH)mm	Centre	Wall
LTAB06600	600 x 600 x 600	£345	£350
LTAB09600	900 x 600 x 600	£402	£411
LTAB12600	1200 x 600 x 600	£446	£461
LTAB15600	1500 x 600 x 600	£479	£494
LTAB18600	1800 x 600 x 600	£515	£529

700mm	(WxDxH)mm	Centre	Wall
LTAB06700	600 x 700 x 600	£376	£388
LTAB09700	900 x 700 x 600	£442	£452
LTAB12700	1200 x 700 x 600	£482	£491
LTAB15700	1500 x 700 x 600	£512	£525
LTAB18700	1800 x 700 x 600	£529	£538

Other sizes are available.

Call Sales on **01332 875544** to talk to our fabrication team.



## Stainless Steel Tables with Two Undershelves

- Tops manufactured from high grade 304 stainless steel
- Undershelves manufactured from 430 grade stainless steel
- Available as self assembly or assembled
- Can have an upstand for wall benches just specify a rear upstand
- Legs built from 30mm box section
- Welded frame
- Larger sizes available

£POA



## Optional Extras

- Special cut outs (specify location) to fit round pipe and pillars **£169**
- Fitted standard rubber scrap ring **£97**
- Standard side panels left or right **£102**
- Factory fitted sliding doors per metre **£367**
- Extra strengthening per metre **£44**
- Extra upstand (specify left or right hand) per table **£56**
- Drawers for table single drawer 390 x 550 x 115mm **£225**
- Special chamfers **£131**
- Castors 50mm **£79**
- Castors 75mm **£100**
- Castors 100mm **£143**

Image for illustrative purposes only - product may vary.  
Technical Drawing on page 90

## Valance Options

- Up to 1200x300mm stainless steel valance **£66**
- Up to 1500x300mm stainless steel valance **£76**
- Up to 1800x300mm stainless steel valance **£103**

600mm	(WxDxH)mm	Centre	Wall
TAB06600/2	600 x 600 x 900	<b>£433</b>	<b>£452</b>
TAB09600/2	900 x 600 x 900	<b>£441</b>	<b>£459</b>
TAB12600/2	1200 x 600 x 900	<b>£550</b>	<b>£562</b>
TAB15600/2	1500 x 600 x 900	<b>£592</b>	<b>£604</b>
TAB18600/2	1800 x 600 x 900	<b>£618</b>	<b>£630</b>
TAB21600/2	2100 x 600 x 900	<b>£1116</b>	<b>£1147</b>
TAB24600/2	2400 x 600 x 900	<b>£1137</b>	<b>£1169</b>

700mm	(WxDxH)mm	Centre	Wall
TAB06700/2	600 x 700 x 900	<b>£445</b>	<b>£458</b>
TAB09700/2	900 x 700 x 900	<b>£484</b>	<b>£496</b>
TAB12700/2	1200 x 700 x 900	<b>£621</b>	<b>£632</b>
TAB15700/2	1500 x 700 x 900	<b>£654</b>	<b>£667</b>
TAB18700/2	1800 x 700 x 900	<b>£677</b>	<b>£691</b>
TAB21700/2	2100 x 700 x 900	<b>£1142</b>	<b>£1174</b>
TAB24700/2	2400 x 700 x 900	<b>£1160</b>	<b>£1184</b>

Other sizes are available.

Call Sales on **01332 875544** to talk to our fabrication team.

# Tables

## Stainless Steel Table with Part Undershelf LH/RH

- Tables - with half undershelf (left/right side)
- Tops manufactured from high grade 304 stainless steel
- Undershelves manufactured from 430 grade stainless steel
- Can have an upstand for wall benches just specify a rear upstand
- Void can be specified to suit appliances
- Legs built from 30mm box section
- Welded frame
- Larger sizes available

£POA

## Optional Extras

- Special cut outs (specify location) to fit round pipe and pillars **£169**
- Fitted standard rubber scrap ring **£97**
- Standard side panels left or right **£102**
- Factory fitted sliding doors per metre **£367**
- Extra strengthening per metre **£44**
- Extra upstand (specify left or right hand) per table **£56**
- Drawers for table single drawer 390 x 550 x 115mm **£225**
- Special chamfers **£131**
- Castors 50mm **£79**
- Castors 75mm **£100**
- Castors 100mm **£143**



Table legs: 30mm box section

Image of left hand shown for illustrative purposes only - product may vary.  
Technical Drawing on page 91

## Valance Options

- Up to 1200x300mm stainless steel valance **£66**
- Up to 1500x300mm stainless steel valance **£76**
- Up to 1800x300mm stainless steel valance **£103**

## Left Hand

600mm	(WxDxH)mm	Centre £	Wall £
TABHL12600	1200 x 600 x 900	<b>£458</b>	<b>£467</b>
TABHL15600	1500 x 600 x 900	<b>£491</b>	<b>£503</b>
TABHL18600	1800 x 600 x 900	<b>£517</b>	<b>£531</b>
TABHL21600	2100 x 600 x 900	<b>£883</b>	<b>£915</b>
TABHL24600	2400 x 600 x 900	<b>£899</b>	<b>£931</b>

700mm	(WxDxH)mm	Centre £	Wall £
TABHL12700	1200 x 700 x 900	<b>£529</b>	<b>£538</b>
TABHL15700	1500 x 700 x 900	<b>£564</b>	<b>£571</b>
TABHL18700	1800 x 700 x 900	<b>£586</b>	<b>£610</b>
TABHL21700	2100 x 700 x 900	<b>£909</b>	<b>£941</b>
TABHL24700	2400 x 700 x 900	<b>£930</b>	<b>£951</b>

## Right Hand

600mm	(WxDxH)mm	Centre £	Wall £
TABHR12600	1200 x 600 x 900	<b>£458</b>	<b>£467</b>
TABHR15600	1500 x 600 x 900	<b>£491</b>	<b>£503</b>
TABHR18600	1800 x 600 x 900	<b>£517</b>	<b>£531</b>
TABHR21600	2100 x 600 x 900	<b>£883</b>	<b>£915</b>
TABHR24600	2400 x 600 x 900	<b>£899</b>	<b>£931</b>

700mm	(WxDxH)mm	Centre £	Wall £
TABHR12700	1200 x 700 x 900	<b>£529</b>	<b>£538</b>
TABHR15700	1500 x 700 x 900	<b>£564</b>	<b>£571</b>
TABHR18700	1800 x 700 x 900	<b>£586</b>	<b>£610</b>
TABHR21700	2100 x 700 x 900	<b>£909</b>	<b>£941</b>
TABHR24700	2400 x 700 x 900	<b>£930</b>	<b>£951</b>

Other sizes are available.

Call Sales on **01332 875544** to talk to our fabrication team.

## Stainless Steel Tables with Void

- Tables - with no undershelf
  - Manufactured from high grade stainless steel
  - Can have an upstand for wall benches, please specify at the time of ordering 'a rear upstand'
  - Legs built from 30mm box section
  - Welded frame
  - Larger sizes available
- £POA**

## Optional Extras

- Special cut outs (specify location) to fit round pipe and pillars **£169**
- Fitted standard rubber scrap ring **£97**
- Standard side panels left or right **£102**
- Factory fitted sliding doors per metre **£367**
- Extra strengthening per metre **£44**
- Extra upstand (specify left or right hand) per table **£56**
- Drawers for table single drawer 390 x 550 x 115mm **£225**
- Special chamfers **£131**
- Castors 50mm **£79**
- Castors 75mm **£100**
- Castors 100mm **£143**



Image for illustrative purposes only - product may vary.  
Technical Drawing on page 91

## Valance Options

- Up to 1200x300mm stainless steel valance **£66**
- Up to 1500x300mm stainless steel valance **£76**
- Up to 1800x300mm stainless steel valance **£103**

Please note: The tie bars are attached by zip ties for transportation purposes. Once in situ these need to be removed.

600mm	(WxDxH)mm	Centre	Wall
TABN06600	600 x 600 x 900	<b>£293</b>	<b>£306</b>
TABN09600	900 x 600 x 900	<b>£325</b>	<b>£336</b>
TABN12600	1200 x 600 x 900	<b>£394</b>	<b>£404</b>
TABN15600	1500 x 600 x 900	<b>£427</b>	<b>£440</b>
TABN18600	1800 x 600 x 900	<b>£467</b>	<b>£467</b>
TABN21600	2100 x 600 x 900	<b>£813</b>	<b>£845</b>
TABN24600	2400 x 600 x 900	<b>£825</b>	<b>£857</b>

700mm	(WxDxH)mm	Centre	Wall
TABN06700	600 x 700 x 900	<b>£317</b>	<b>£330</b>
TABN09700	900 x 700 x 900	<b>£355</b>	<b>£392</b>
TABN12700	1200 x 700 x 900	<b>£465</b>	<b>£475</b>
TABN15700	1500 x 700 x 900	<b>£500</b>	<b>£508</b>
TABN18700	1800 x 700 x 900	<b>£522</b>	<b>£547</b>
TABN21700	2100 x 700 x 900	<b>£820</b>	<b>£851</b>
TABN24700	2400 x 700 x 900	<b>£841</b>	<b>£872</b>

Other sizes are available.

Call Sales on **01332 875544** to talk to our fabrication team.



# Flatpack Table



The ultimate stainless steel mobile table



From flatpack  
to fully ready in under  
30 seconds



**1** The heavy duty 30mm stainless steel box section frames slot together with bespoke hinges

**2** The heavy duty stainless steel undershelf locates in the support angles

**3** The high quality stainless steel top is placed onto the frame and locks the table solidly together using a 5mm Allen Key (supplied).

## Stainless Steel Flatpack Tables with One Undershelf

- New fast self-assembly design that takes 30 seconds to assemble
- Totally portable and ideal for event catering
- Take it anywhere, use it, then pack it away
- Robust and practical design suitable for all types of applications from commercial kitchens to laboratories
- Manufactured from high grade stainless steel
- Table folds down to 150mm high when collapsed



All the tools you need.  
Put it together with the **supplied 5mm Allen Key** and it's ready to go.

## Accessories

Choose your accessories for your flatpack table

- 50mm castors **£79**
- 75mm castors **£100**
- 100mm castors **£143**

600mm	(WxDxH)mm	Centre	Wall
FTAB06600	600 x 600 x 900	£307	£320
FTAB09600	900 x 600 x 900	£330	£344
FTAB12600	1200 x 600 x 900	£385	£394
FTAB15600	1500 x 600 x 900	£403	£421
FTAB18600	1800 x 600 x 900	£429	£448

650mm	(WxDxH)mm	Centre	Wall
FTAB06650	600 x 650 x 900	£320	£333
FTAB09650	900 x 650 x 900	£344	£356
FTAB12650	1200 x 650 x 900	£423	£427
FTAB15650	1500 x 650 x 900	£444	£465
FTAB18650	1800 x 650 x 900	£478	£501

700mm	(WxDxH)mm	Centre	Wall
FTAB06700	600 x 700 x 900	£344	£357
FTAB09700	900 x 700 x 900	£367	£381
FTAB12700	1200 x 700 x 900	£448	£465
FTAB15700	1500 x 700 x 900	£498	£523
FTAB18700	1800 x 700 x 900	£548	£565

# Folding Table

**FEATURES**

- Mobile table for event catering
- Folds down to 50mm high
- 4 castors included

Model No.	Description (wxdxh)	Price
FGTAB18650C	1850x650x850mm	£632

FOLDED





# Equipment Stands

## PST3 / 4 / 6 / 7

### Stainless Steel Equipment Stands

#### FEATURES

- Manufactured from 30mm box section
- 4 adjustable feet
- Corner mounts built into the top of the frames to ensure equipment sits safely in place
- Ideal for all Parry countertop products
- Manufactured from high quality stainless steel



PST7 shown

Model No.	(WxDxH)mm	WT (kg)	Price £	Suitable For
PST3	300 x 580 x 626	6.5	£251	NPSF3, NPSF6, NPSF9, NPWB2
PST4	450 x 580 x 626	7.0	£276	NPWB4
PST6	600 x 580 x 626	8.5	£294	NPDF3, NPDF6, NPDF9, PGG6, PGG6P, PG6, PGC6, PGC6P
PST7	750 x 580 x 626	10.5	£352	PGG7, PGG7P, PG7, NPWB6
ST-AG2H	300 x 618 x 700	7.5	£POA	AG2H, AG2HP
ST-AG4H	600 x 618 x 700	7.5	£POA	AG4H, AG4HP
ST-AG6H	900 x 618 x 700	7.5	£POA	AG6H, AG6HP

## Combi Stand

#### FEATURES

- Manufactured from 30mm box section
- 4 adjustable feet
- Space for up to 10 GN pans underneath
- Corner mounts built into the top of the frames to ensure equipment sits safely in place
- Ideal for all types of combination ovens
- Manufactured from high quality stainless steel



Model No.	(WxDxH)mm	WT (kg)	Price £
COMBISTAND5	Bespoke	-	£998





# Shelves and Racks

## Storage Shelves - Wall Shelves

- Comes complete with pre-drilled brackets
- Manufactured from high quality stainless steel
- Fixings not included



Image for illustrative purposes only - product may vary



If box section brackets are required, please add 'B' to the product code

300mm range	(WxD)mm	Price
SHELF3W900	900 x 300	£116
SHELF3W1200	1200 x 300	£126
SHELF3W1500	1500 x 300	£151
SHELF3W1800	1800 x 300	£161

400mm range	(WxD)mm	Price
SHELF4W900	900 x 400	£145
SHELF4W1200	1200 x 400	£160
SHELF4W1500	1500 x 400	£196
SHELF4W1800	1800 x 400	£210

## Storage Shelves Microwave Wall Shelves

- Comes complete with pre-drilled brackets
- Manufactured from high quality stainless steel
- Fixings not included

400mm range	(WxD)mm	Price
SHELFM6X4	600 x 400	£148

500mm range	(WxD)mm	Price
SHELFM6X5	600 x 500	£157

600mm range	(WxD)mm	Price
SHELFM6X6	600 x 600	£164



Image for illustrative purposes only - product may vary

Image for illustrative purposes only - product may vary

## Stainless Steel Gastronorm Pan Trolley

- Can be manufactured to accommodate any size pan - POA
- Manufactured from high quality stainless steel
- SCT1600 fits 20 x 1/1 gastronorm pans, SCT900 fits 10 x 1/1 gastronorm pans

Model No.	(WxDxH)mm	Specification	Price
SCT900	670x530x900mm	10-tier supports pans up to 530x370mm (65mm between shelves)	£420
SCT1600	670x530x1670mm	20-tier supports pans up to 530x370mm (65mm between shelves)	£484



Other sizes are available.

Call Sales on **01332 875544** to talk to our fabrication team.

# Shelves and Racks

## Stainless Steel Storage Racks with 3 Shelves and Adjustable Feet

- Adjustable feet
- 300mm deep (will require a wall tie bar)
- Variable height shelving (only on self assembly)
- Manufactured from high quality stainless steel
- Available as self assembly or fully assembled
- Extra shelves available from **£53**

Please specify when ordering if fully welded or flat packed.



Image for illustrative purposes only - product may vary.  
Technical Drawing on page 93

**Variable Height Shelving**

All of our Self Assembly shelving allows for fully customisable shelf location - giving you the flexibility with shelf heights that are right for you.

**Perforated Shelves Available**

All of our Self Assembly shelving can be specified with fully perforated stainless steel shelves, perfect for environments where airflow around and drainage of anything you are storing is required. £100

**Please Note: All fully assembled units have shelves spaced evenly. If you require a different configuration please specify when ordering. If perforated shelves required, please call the sales team for more information.**

400mm	(WxDxH)mm	Flat Pack	Solid
RACK3S12400	1200 x 400 x 1200	<b>£380</b>	<b>£474</b>
RACK3S15400	1500 x 400 x 1200	<b>£380</b>	<b>£474</b>
RACK3S18400	1800 x 400 x 1200	<b>£380</b>	<b>£474</b>

500mm	(WxDxH)mm	Flat Pack	Solid
RACK3S12500	1200 x 500 x 1200	<b>£448</b>	<b>£542</b>
RACK3S15500	1500 x 500 x 1200	<b>£448</b>	<b>£542</b>
RACK3S18500	1800 x 500 x 1200	<b>£448</b>	<b>£542</b>

600mm	(WxDxH)mm	Flat Pack	Solid
RACK3S12600	1200 x 600 x 1200	<b>£495</b>	<b>£589</b>
RACK3S15600	1500 x 600 x 1200	<b>£495</b>	<b>£589</b>
RACK3S18600	1800 x 600 x 1200	<b>£495</b>	<b>£589</b>

Other sizes are available.

Call Sales on **01332 875544** to talk to our fabrication team.

## Stainless Steel Storage Racks with 4 Shelves and Adjustable Feet

- Adjustable feet
- 300mm deep (will require a wall tie bar)
- Variable height shelving (only on self assembly)
- Manufactured from high quality stainless steel
- Available as self assembly or fully assembled
- Extra shelves available from **£53**

Please specify when ordering if fully welded or flat packed.



Image for illustrative purposes only - product may vary.  
Technical Drawing on page 93

### Variable Height Shelving

All of our Self Assembly shelving allows for fully customisable shelf location - giving you the flexibility with shelf heights that are right for you.



### Perforated Shelves Available

All of our Self Assembly shelving can be specified with fully perforated stainless steel shelves, perfect for environments where airflow around and drainage of anything you are storing is required. £100



Please Note: All fully assembled units have shelves spaced evenly.  
If you require a different configuration please specify when ordering.  
If perforated shelves required, please call the sales team for more information.

400mm	(WxDxH)mm	Flat Pack	Solid
RACK4S12400	1200 x 400 x 1500	£552	£646
RACK4S15400	1500 x 400 x 1500	£552	£646
RACK4S18400	1800 x 400 x 1500	£552	£646

500mm	(WxDxH)mm	Flat Pack	Solid
RACK4S12500	1200 x 500 x 1500	£563	£657
RACK4S15500	1500 x 500 x 1500	£563	£657
RACK4S18500	1800 x 500 x 1500	£563	£657

600mm	(WxDxH)mm	Flat Pack	Solid
RACK4S12600	1200 x 600 x 1500	£563	£657
RACK4S15600	1500 x 600 x 1500	£563	£657
RACK4S18600	1800 x 600 x 1500	£563	£657

Other sizes are available.

Call Sales on **01332 875544** to talk to our fabrication team.



# Shelves and Racks

## Stainless Steel Storage Racks with 5 Shelves and Adjustable Feet

- Adjustable feet
- 300mm deep (will require a wall tie bar)
- Variable height shelving (only on self assembly)
- Manufactured from high quality stainless steel
- Available as self assembly or fully assembled
- Extra shelves available from **£53**

Please specify when ordering if fully welded or flat packed.



Image for illustrative purposes only - product may vary.  
Technical Drawing on page 93

### Variable Height Shelving

All of our Self Assembly shelving allows for fully customisable shelf location - giving you the flexibility with shelf heights that are right for you.



### Perforated Shelves Available

All of our Self Assembly shelving can be specified with fully perforated stainless steel shelves, perfect for environments where airflow around and drainage of anything you are storing is required. £100



Please Note: All fully assembled units have shelves spaced evenly.  
If you require a different configuration please specify when ordering.  
If perforated shelves required, please call the sales team for more information.

400mm	(WxDxH)mm	Flat Pack	Solid
RACK5S12400	1200 x 400 x 1800	£611	£705
RACK5S15400	1500 x 400 x 1800	£611	£705
RACK5S18400	1800 x 400 x 1800	£611	£705

500mm	(WxDxH)mm	Flat Pack	Solid
RACK5S12500	1200 x 500 x 1800	£693	£787
RACK5S15500	1500 x 500 x 1800	£693	£787
RACK5S18500	1800 x 500 x 1800	£693	£787

600mm	(WxDxH)mm	Flat Pack	Solid
RACK5S12600	1200 x 600 x 1800	£693	£787
RACK5S15600	1500 x 600 x 1800	£693	£787
RACK5S18600	1800 x 600 x 1800	£693	£787

Other sizes are available.

Call Sales on **01332 875544** to talk to our fabrication team.

## Stainless Steel Storage Racks with 6 Shelves and Adjustable Feet

- Adjustable feet
- 300mm deep (will require a wall tie bar)
- Variable height shelving (only on self assembly)
- Manufactured from high quality stainless steel
- Available as self assembly or fully assembled
- Extra shelves available from **£53**

Please specify when ordering if fully welded or flat packed.



Image for illustrative purposes only - product may vary.  
Technical Drawing on page 93

### Variable Height Shelving

All of our Self Assembly shelving allows for fully customisable shelf location - giving you the flexibility with shelf heights that are right for you.



### Perforated Shelves Available

All of our Self Assembly shelving can be specified with fully perforated stainless steel shelves, perfect for environments where airflow around and drainage of anything you are storing is required. £100



Please Note: All fully assembled units have shelves spaced evenly.  
If you require a different configuration please specify when ordering.  
If perforated shelves required, please call the sales team for more information.

400mm	(WxDxH)mm	Flat Pack	Solid
RACK6S12400	1200 x 400 x 2000	£775	£869
RACK6S15400	1500 x 400 x 2000	£775	£869
RACK6S18400	1800 x 400 x 2000	£775	£869

500mm	(WxDxH)mm	Flat Pack	Solid
RACK6S12500	1200 x 500 x 2000	£877	£971
RACK6S15500	1500 x 500 x 2000	£877	£971
RACK6S18500	1800 x 500 x 2000	£877	£971

600mm	(WxDxH)mm	Flat Pack	Solid
RACK6S12600	1200 x 600 x 2000	£940	£1034
RACK6S15600	1500 x 600 x 2000	£965	£1060
RACK6S18600	1800 x 600 x 2000	£965	£1060

Other sizes are available.  
Call Sales on **01332 875544** to talk to our fabrication team.

# Shelves and Racks

## Stainless Steel Chef's Rack Single Tier

- Manufactured from high quality stainless steel
- Complete with pre-drilled brackets
- Fully assembled only
- Trolley fixing bracket design available - please specify when ordering
- Larger sizes available

£POA



Image for illustrative purposes only - product may vary.



### Require Heat?

Our chef racks are available either ambient or heated. Our heated units use quartz lights to give great illumination from a small source.

Optional dimmer switch

£165

250mm range	(WxDxH)mm	Ambient	Heated
SHELFST10250	1000 x 250 x 400	£313	£613
SHELFST12250	1200 x 250 x 400	£313	£613
SHELFST15250	1500 x 250 x 400	£325	£655
SHELFST18250	1800 x 250 x 400	£397	£807

300mm range	(WxDxH)mm	Ambient	Heated
SHELFST10300	1000 x 300 x 400	£320	£621
SHELFST12300	1200 x 300 x 400	£320	£621
SHELFST15300	1500 x 300 x 400	£332	£662
SHELFST18300	1800 x 300 x 400	£405	£815

350mm range	(WxDxH)mm	Ambient	Heated
SHELFST10350	1000 x 350 x 400	£327	£627
SHELFST12350	1200 x 350 x 400	£327	£627
SHELFST15350	1500 x 350 x 400	£339	£669
SHELFST18350	1800 x 350 x 400	£415	£824

400mm range	(WxDxH)mm	Ambient	Heated
SHELFST10400	1000 x 400 x 400	£334	£633
SHELFST12400	1200 x 400 x 400	£334	£633
SHELFST15400	1500 x 400 x 400	£347	£677
SHELFST18400	1800 x 400 x 400	£423	£833



Image for illustrative purposes only - product may vary.

## Stainless Steel Chef's Rack Double Tier

- Manufactured from high quality stainless steel
- Complete with pre-drilled brackets
- Fully assembled only
- Larger sizes available

£POA

250mm range	(WxDxH)mm	Ambient	Heated
SHELFST10250	1000 x 250 x 700	£388	£987
SHELFST12250	1200 x 250 x 700	£388	£987
SHELFST15250	1500 x 250 x 700	£399	£1060
SHELFST18250	1800 x 250 x 700	£489	£1309

300mm range	(WxDxH)mm	Ambient	Heated
SHELFST10300	1000 x 300 x 700	£398	£998
SHELFST12300	1200 x 300 x 700	£398	£998
SHELFST15300	1500 x 300 x 700	£408	£1069
SHELFST18300	1800 x 300 x 700	£502	£1321

350mm range	(WxDxH)mm	Ambient	Heated
SHELFST10350	1000 x 350 x 700	£406	£1006
SHELFST12350	1200 x 350 x 700	£406	£1006
SHELFST15350	1500 x 350 x 700	£417	£1077
SHELFST18350	1800 x 350 x 700	£512	£1332

400mm range	(WxDxH)mm	Ambient	Heated
SHELFST10400	1000 x 400 x 700	£416	£1016
SHELFST12400	1200 x 400 x 700	£416	£1016
SHELFST15400	1500 x 400 x 700	£426	£1088
SHELFST18400	1800 x 400 x 700	£526	£1344



## Stainless Steel Chef's Rack Triple Tier

- Manufactured from high quality stainless steel
- Complete with pre-drilled brackets
- Fully assembled only
- Larger sizes available

£POA



Image for illustrative purposes only - product may vary.



### Require Heat?

Our chef racks are available either ambient or heated. Our heated units use quartz lights to give great illumination from a small source.

**Optional dimmer switch**      **£165**

250mm range	(WxDxH)mm	Ambient	Heated
SHELF3T10250	1000 x 250 x 900	£466	£1366
SHELF3T12250	1200 x 250 x 900	£466	£1366
SHELF3T15250	1500 x 250 x 900	£480	£1470
SHELF3T18250	1800 x 250 x 900	£589	£1820

300mm range	(WxDxH)mm	Ambient	Heated
SHELF3T10300	1000 x 300 x 900	£513	£1414
SHELF3T12300	1200 x 300 x 900	£513	£1414
SHELF3T15300	1500 x 300 x 900	£529	£1519
SHELF3T18300	1800 x 300 x 900	£649	£1880

350mm range	(WxDxH)mm	Ambient	Heated
SHELF3T10350	1000 x 350 x 900	£559	£1460
SHELF3T12350	1200 x 350 x 900	£559	£1460
SHELF3T15350	1500 x 350 x 900	£576	£1566
SHELF3T18350	1800 x 350 x 900	£710	£1939

400mm range	(WxDxH)mm	Ambient	Heated
SHELF3T10400	1000 x 400 x 900	£610	£1511
SHELF3T12400	1200 x 400 x 900	£610	£1511
SHELF3T15400	1500 x 400 x 900	£628	£1619
SHELF3T18400	1800 x 400 x 900	£776	£2006

Please Note: Each heated gantry comes on a 13amp plug, per heated shelf. Number of lights - 1000mm unit has 2 lights, 1200mm unit has 3 lights, 1500mm unit has 4 lights, 1800mm unit has 5 lights. Other options available upon request.

Other sizes are available.  
Call Sales on **01332 875544** to talk to our fabrication team.

# Flatpack Cupboard



## The ultimate flatpack stainless steel mobile cupboard



From flatpack to fully ready in under 5 minutes

1

Designed as an easily transportable flatpack to give flexibility, mobility and space saving storage.



2

The heavy duty 30mm stainless steel box section frames slot together with bespoke hinges.



3

The heavy duty stainless steel undershelf locates in the support angles.



4

The stainless steel rear panel is fixed in place with a 5mm Allen Key.



5

The high quality stainless steel door panels slot into position, no tools required



6

The high quality stainless steel top is placed onto the cupboard and locks the table solidly together using a 5mm Allen Key (supplied).





Image for illustrative purposes only - shown with optional castors.

## Stainless Steel Flatpack Cupboard

- New fast self-assembly design that takes under 5 minutes to assemble
- Totally portable and ideal for event catering
- Take it anywhere, use it, then pack it away
- Robust and practical design suitable for all types of applications from commercial kitchens to laboratories
- Manufactured from high grade stainless steel



All the tools you need.  
Put it together with the **supplied 5mm Allen Key** and it's ready to go.

## Optional Extras

- Castors 100mm **£143**

600mm	(WxDxH)mm	Price
FCUP12600	1200 x 600 x 900	<b>£1184</b>
FCUP15600	1500 x 600 x 900	<b>£1576</b>
FCUP18600	1800 x 600 x 900	<b>£1581</b>
FCUP12600P passthrough	1200 x 600 x 900	<b>£1467</b>
FCUP15600P passthrough	1500 x 600 x 900	<b>£1853</b>
FCUP18600P passthrough	1800 x 600 x 900	<b>£1860</b>

650mm	(WxDxH)mm	Price
FCUP12650	1200 x 650 x 900	<b>£1225</b>
FCUP15650	1500 x 650 x 900	<b>£1612</b>
FCUP18650	1800 x 650 x 900	<b>£1666</b>
FCUP12650P passthrough	1200 x 650 x 900	<b>£1504</b>
FCUP15650P passthrough	1500 x 650 x 900	<b>£1890</b>
FCUP18650P passthrough	1800 x 650 x 900	<b>£1944</b>

700mm	(WxDxH)mm	Price
FCUP12700	1200 x 700 x 900	<b>£1481</b>
FCUP15700	1500 x 700 x 900	<b>£1649</b>
FCUP18700	1800 x 700 x 900	<b>£1686</b>
FCUP12700P passthrough	1200 x 700 x 900	<b>£1759</b>
FCUP15700P passthrough	1500 x 700 x 900	<b>£1927</b>
FCUP18700P passthrough	1800 x 700 x 900	<b>£1964</b>

Other sizes are available.  
Call Sales on **01332 875544** to talk to our fabrication team.



# COSHH Cupboards

## COSHH Cupboard

### FEATURES

- Manufactured from high grade stainless steel
- Height adjustable feet
- Supplied with 3 fully adjustable perforated shelves
- Locks available on request
- 2 heights of cupboard available

Model No.	Description	(WxDxH)mm	Price £
COSHS1800	Single door COSHH Cupboard	600 x 600 x 1800	<b>£13467</b>
COSHS900	Single door COSHH Cupboard	600 x 600 x 900	<b>£1240</b>
COSHD1800	Double door COSHH Cupboard	900 x 600 x 1800	<b>£1969</b>
COSHD900	Double door COSHH Cupboard	900 x 600 x 900	<b>£1471</b>

BESPOKE SIZES AVAILABLE - Call sales on 01332 875544 for details



# 3 Door Base Cabinets



## 3 Door Base Counter Cabinet

- Manufactured from high quality stainless steel
- Internal sectionalised shelves
- 2 and 4 door designs also available
- Locking doors available
- Larger sizes available

£POA

Model No.	(WxDxH)mm	WT (kg)	Price £
3DBC	1500 x 750 x 900	123	<b>£1880</b>

## Accessories

Accessories for your 3DBC and 3DBCTCS

- Lit or unlit rack/shelves
- Cupboard tops
- Additional internal shelves
- 2 or 4 door configuration
- Locking doors



Image shown with 3M Architectural Finishes DI-NOC wrap applied

## 3 Door Base Counter Cabinet with Sink and Cupboard top

- Manufactured from high quality stainless steel
- Internal sectionalised shelves
- Sliding cupboard doors
- 2 and 4 door designs also available
- Locking doors available
- Larger sizes available
- Taps sold seperatly, see page 63

Model No.	(WxDxH)mm	WT (kg)	Price £
3DBCTCS	1500 x 750 x 900	155	<b>£2809</b>



Other sizes are available.

Call Sales on **01332 875544** to talk to our fabrication team.

# Corner and Drawer Units

## Stainless Steel Corner Unit

- Manufactured from high quality stainless steel
- Ambient unit with hinged door to front
- Door can be made lockable
- Adjustable feet
- Includes removable internal triangular shelf
- Triangular shelf can be fitted in one of three positions inside the unit
- Designed for easy access and self assembly
- Breaks down to fit through standard doorways
- Extra shelves available



CUPBD600

Image for illustrative purposes only - product may vary

## Accessories

- Additional shelf **£191**

Model No.	(WxDxH)mm	Price
CUPBD600 - Stainless Steel Corner Unit	955x600x900mm	<b>£1177</b>
CUPBD650 - Stainless Steel Corner Unit	1005x650x900mm	<b>£1240</b>
CUPBD700 - Stainless Steel Corner Unit	1055x700x900mm	<b>£1303</b>

## Stainless Steel Drawer Unit

- Manufactured from high quality stainless steel
- Units have a 115mm gap to the back to allow for pipe work
- The top of the unit has a 50mm upstand and a 50mm return to the wall
- Fully galvanized internal structure
- Available in centre and wall options - Add a 'C' to code if centre required
- Drawers are 535mm left to right and 500mm front to back. 3 drawer is 150mm deep, 4 drawer is 112mm deep
- Also available with drawer locks



DRAWER3

Image for illustrative purposes only - product may vary



DRAWER4

Image for illustrative purposes only - product may vary

Model No.	(WxDxH)mm	Price
DRAWER3600 - 3 Drawer Stainless Steel Unit	700x600x900mm	<b>£665</b>
DRAWER3700 - 3 Drawer Stainless Steel Unit	700x700x900mm	<b>£898</b>
DRAWER4600 - 4 Drawer Stainless Steel Unit	700x600x900mm	<b>£737</b>
DRAWER4700 - 4 Drawer Stainless Steel Unit	700x700x900mm	<b>£1020</b>

## Accessories

- Drawer locks **£63 per door**

3M DI-NOC Wrapped

Image for illustrative purposes only - product may vary





# Wall Cupboards

## Stainless Steel Hinged Wall Cupboard

- Manufactured from high quality stainless steel
- Complete with 1 internal shelf, 2 positions
- Wall mounted
- Mounting hole to rear
- Accessories available



WCH750

Image for illustrative purposes only - product may vary

Model No.	(WxDxH)mm	Price
WCH450 - Stainless Steel Wall Cupboard Single Door - hinged	450x330x600mm	£541
WCH600 - Stainless Steel Wall Cupboard Single Door - hinged	600x330x600mm	£544
WCH750 - Stainless Steel Wall Cupboard Double Door - hinged	750x330x600mm	£556
Extra shelf available - please specify when ordering		£99
Locks available - please specify when ordering		£67

## Accessories

- Door locks **£67 per door**
- Additional shelf **£99**
- Sloping tops **£POA**



WCH450

Image for illustrative purposes only - product may vary

## Stainless Steel Sliding Door Wall Cupboard

- Manufactured from high quality stainless steel
- Complete with 1 internal shelf, 2 positions
- Wall mounted
- Mounting hole to rear
- Accessories available



WCS1200

Image for illustrative purposes only - product may vary

Model No.	(WxDxH)mm	Price
WCS900 - Stainless Steel Wall Cupboard - slide door	900x330x600mm	£649
WCS1200 - Stainless Steel Wall Cupboard - slide door	1200x330x600mm	£717
WCS1500 - Stainless Steel Wall Cupboard - slide door	1500x330x600mm	£741
WCS1800 - Stainless Steel Wall Cupboard - slide door	1800x330x600mm	£794
Extra shelf available - please specify when ordering		£99
Locks available - please specify when ordering		£67

# Technical Drawings

The exact measurements of some of our most popular products

## Tables

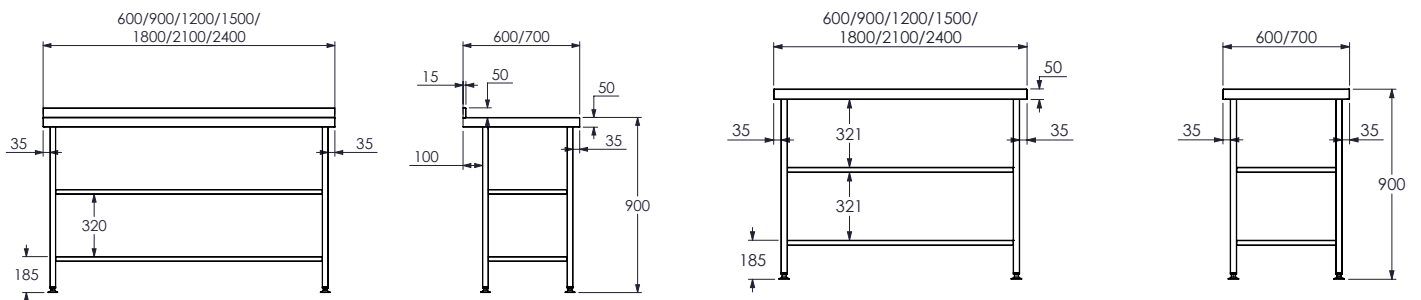

Wall Option

Stainless Steel Tables with Two Undershelves - Page 71

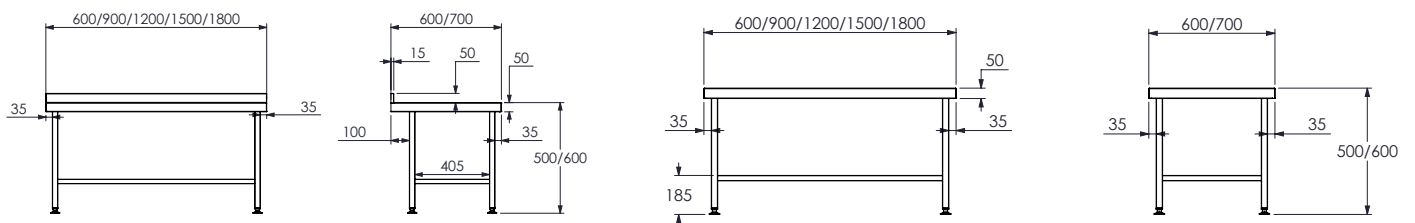

Wall Option

Stainless Steel Low Table - Page 70

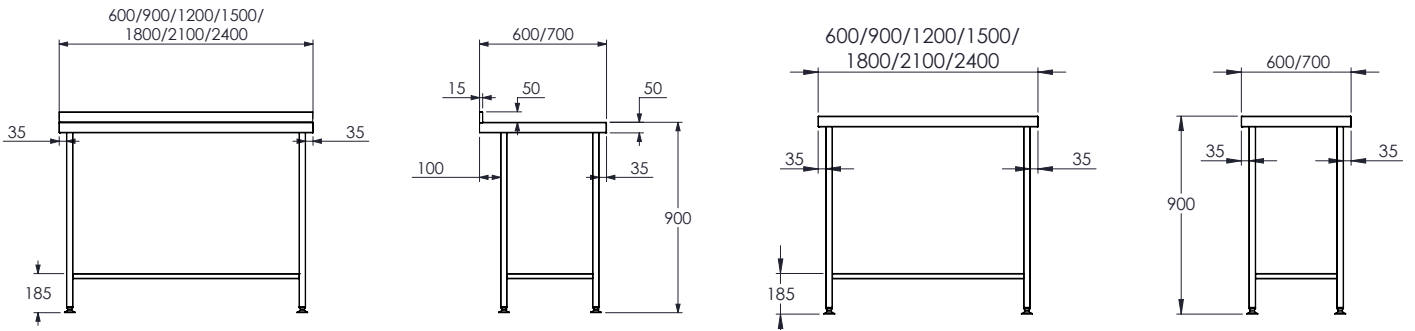

Wall Option

Stainless Steel Tables with One Undershelf - Page 69

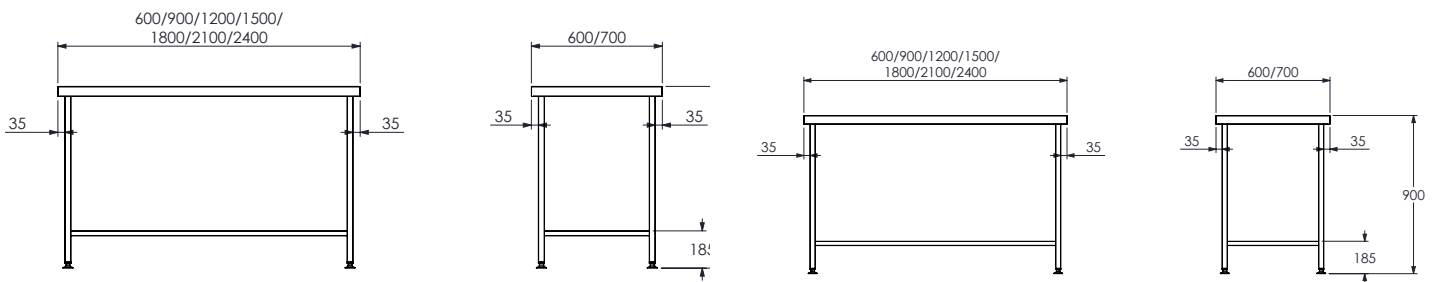

Wall Option

Stainless Steel Tables with Void - Page 73

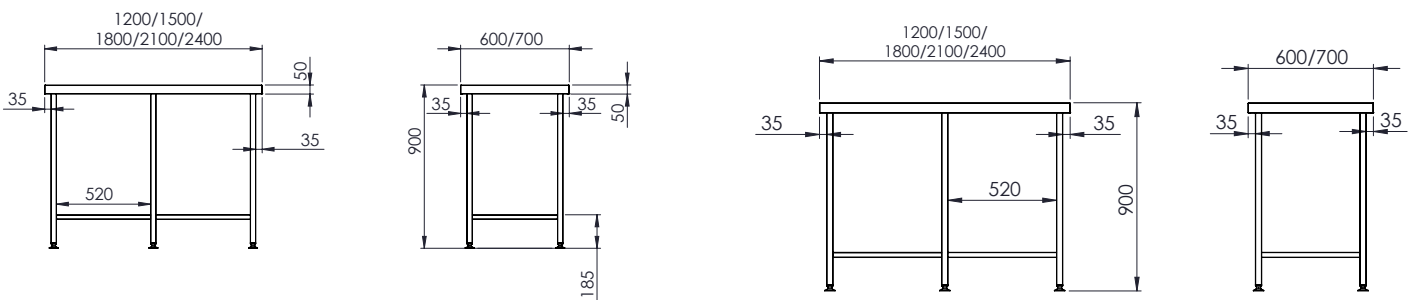

Stainless Steel Table with Part Undershelf  
(left side) - Page 72

Stainless Steel Table with Part Undershelf  
(right side) - Page 72

# Example Dishwasher Tables

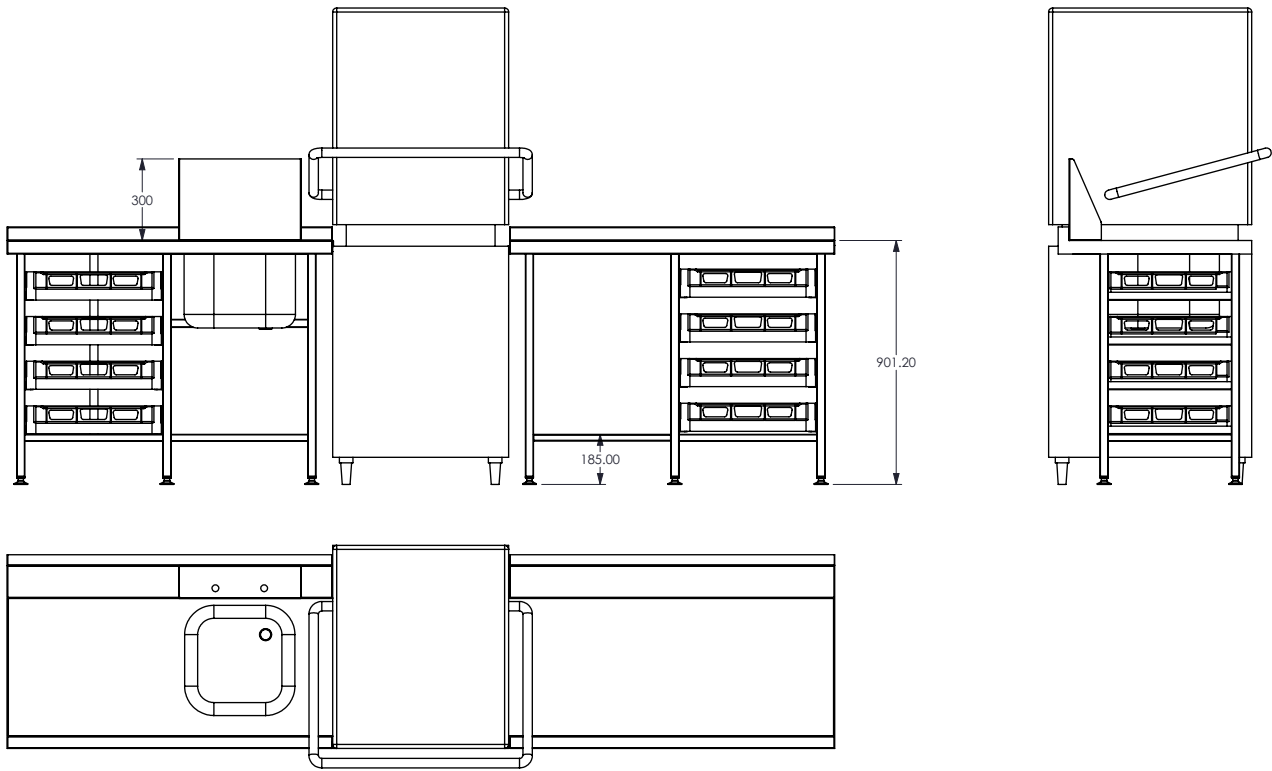

Dishwasher Tables - Page 60

# Example Sink Dimensions

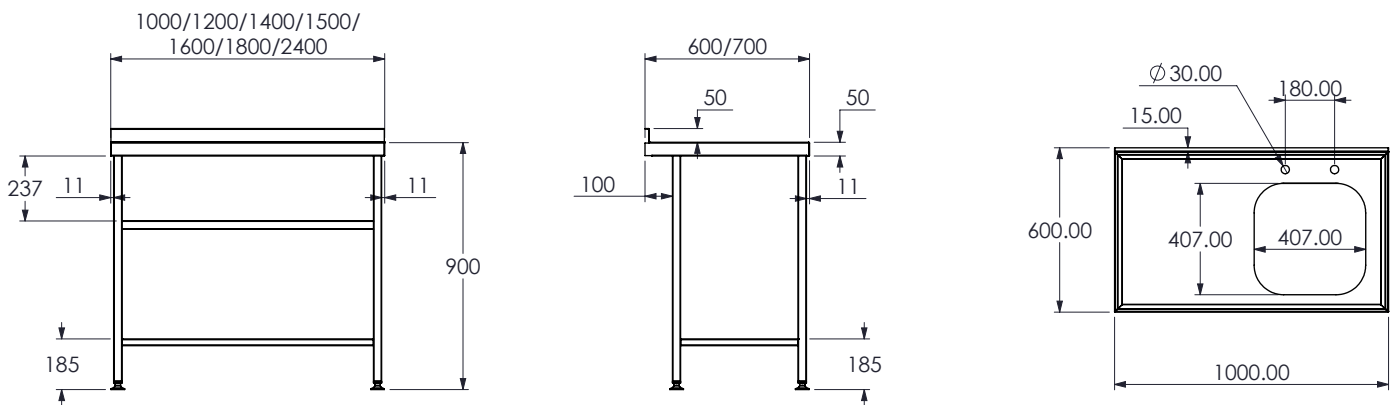

Stainless Steel Fully Assembled Sink - Page 62



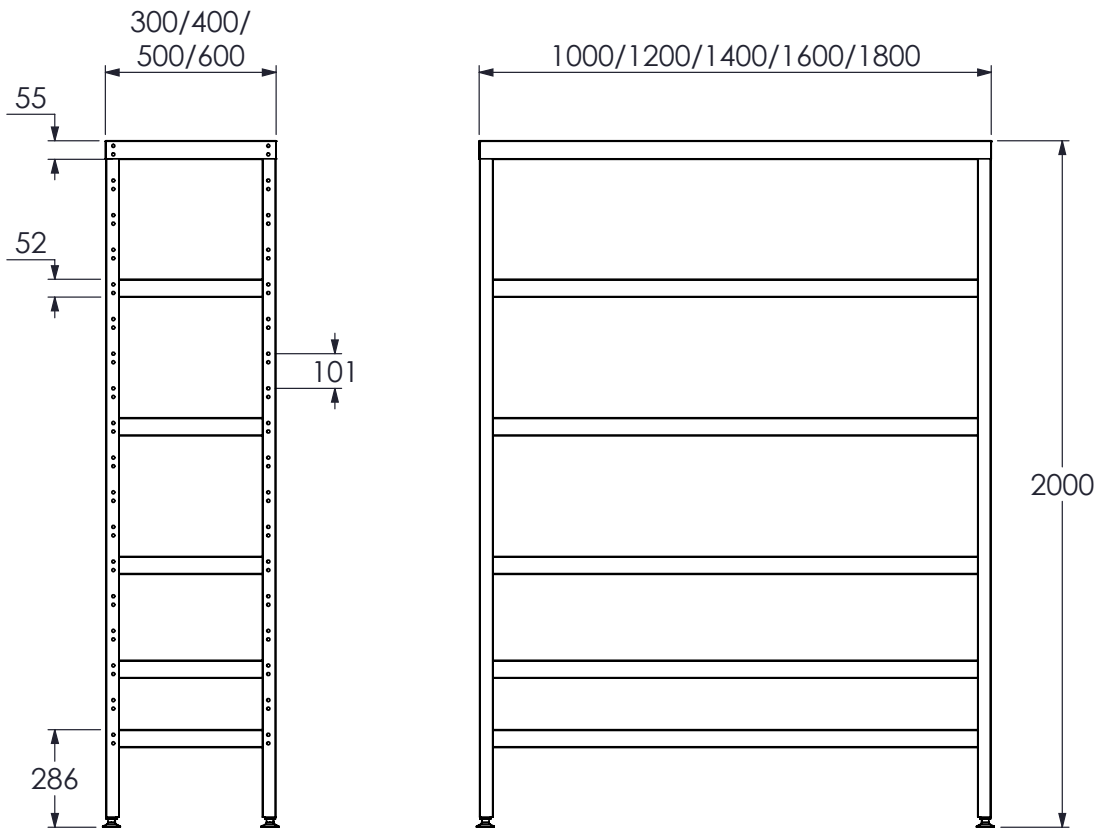

**Stainless Steel Storage Racks with 6 Shelves  
and Adjustable Feet - Page 81**

Dishwasher table section through 'BB'  
Table through to wall - Section View

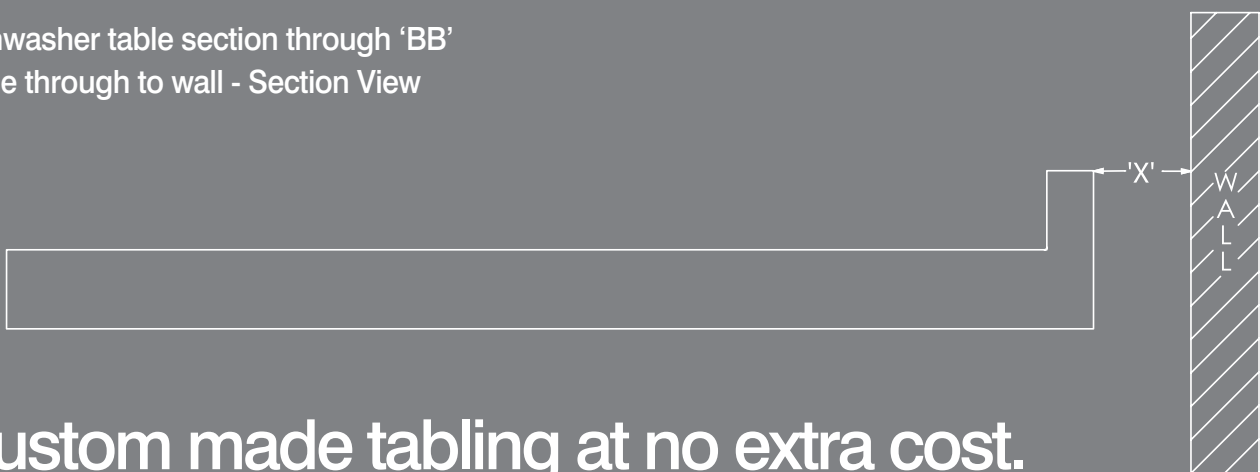

## Custom made tabling at no extra cost.

All dishwasher installations are different depending on your drainage and feed pipes, so the distance from the back of your dishwasher to kitchen wall will be bespoke. This means you will also have a bespoke gap between your dishwasher table and your kitchen wall. We call this gap 'X'.

No problem, simply install your table and measure your gap 'X'. Then ring Parry sales on 01332 875544 and we will manufacture you a bespoke piece that will fit onto your table upstand and up to your kitchen wall at NO EXTRA COST, all that you will pay for is the delivery.

# Stainless Steel Cleaning and Care



## How to keep your Parry Stainless Steel Cleaning Product Clean



### **Day to Day Cleaning**

Most marks, substances or dirt can be removed with a warm damp cloth and mild detergent, making sure you dry the surface with a soft cloth to prevent water marks. For more persistent marks, use a non-abrasive multipurpose cream cleaner, without any added bleach. This is best applied with a soft damp cloth. Heavy duty burnt on grease and dirt may require the use of a non-metal scouring pad in conjunction with a multipurpose cream cleaner.

### **Removing Heavy Marks**

A soap and water solution can be used to clean oil, grease and fingerprints, but a hydrocarbon solvent may be required for more persistent soiling. Extra care must be taken to use the proper safety procedures and precautions if using solvents – in line with COSHH regulations. Glass cleaner is also very effective at removing fingerprints on surfaces with a highly polished finish.

### **Looking After The Stainless Steel Finish**

Any cleaning solutions that contain bleach (sodium chloride) should not be left in contact with stainless steel for longer than 30 minutes maximum. If bleach is necessary, it should be used only in the strength outlined on the manufacturer's instructions and packaging and never left on too long.

### **Preventing Surface Scratches in Stainless Steel**

Never use harsh abrasives or scouring materials for cleaning stainless steel, as they will scratch and leave marks on the surface. Do not use scouring pads, wire brushes or scrapers and make sure they are clean and free from contaminants. Any aggressive cleaning, especially with a soft scouring pad should be carried out along the line of the grain or the metal, never across it as this will help to avoid scratching the steel.

### **Never Leave Surfaces Wet**

It is important to remove anything wet, especially cleaning cloths, pads and containers from the surface as this will avoid water marks and stains. Most domestic dish-washing liquids contain chlorides which if are left in contact with the stainless steel for a prolonged period will likely result in corrosion and pitting marks to form. Please also be aware of silver dip cutlery cleaners as they contain strong acids which are very harmful and quickly cause discoloration and pitting.

# Bespoke Service

Whatever size or design you need our bespoke fabrication service can manufacture most products within our range to your exact requirements upon request.

**For a quote call our bespoke fabrication service now on 01332 875544**

Parry are proud to launch their brand new range of bespoke wrapped finishes. Not only can our high quality stainless steel products be supplied in their natural finish, but we also offer a range of finishes to suit your organisations' image and message.

Choose from one of our selected finishes listed opposite or have your own personalised design applied to your stainless steel product.

We use state of the art 3M™ DI-NOC™ Architectural Finishes vinyl wrap material which is extremely durable and robust.

## Need help with your artwork?

We can print any design you require, all we need is print ready artwork.

**Contact us for details of our art working service on 01332 875544**









**3M Science. Applied to Life.™**



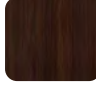
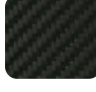

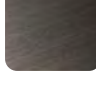
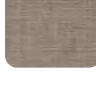
ARCHITECTURAL FINISHES

-  Light Wood
-  Medium Wood
-  Dark Wood
-  Carbon Fibre
-  Block Colour
-  Block Colour
-  Metallic
-  Textured
-  Whiteboard
-  Printed (bespoke)

**Buying your 3M DI-NOC Architectural Finishes is easy!!**

**1**

Choose your Parry product

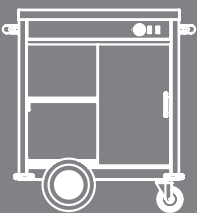

**2**

Choose your DI-NOC Finish

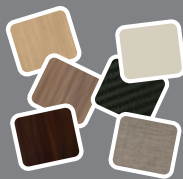

For bespoke designs, email:  
[artwork@parry.co.uk](mailto:artwork@parry.co.uk)

**3**

Place the order with your distributor



**4**

Your wrapped product delivered



Additional wrapping services are available on request, please contact your distributor for more information.  
Visit [parry.co.uk](http://parry.co.uk) for further information on our range of wrapped products.



# FLEXI+SERVE

## The Flexible Servery

Flexi-Serve is the exciting new range of modular servery counters that can quickly and easily be used to create your ideal servery layout.



Parry Catering Equipment is proud to introduce Flexi-Serve. Available as heated, ambient or chilled modules and in sizes accommodating up to 5 gastronorm pans. Flexi-Serve gives you the freedom to design the perfect counter layout to suit your space, customer flow and capacity requirements.

In line with the Parry environmental policy, all Flexi-Serve products have been designed to run on one 13amp plug to minimise power consumption, helping you reduce your organisation's carbon footprint without compromising performance.

For convenience and flexibility, each Flexi-Serve module can be used individually or suited together to form a fixed counter run connected to a single electrical supply.

Flexi-Serve can be further customised using a selection of accessories and bespoke finishes to maximise function, style and branding or display promotional messages such as healthy eating initiatives.

Flexi-Serve will be available in a wide selection of standard sizes, quickly delivered from stock with bespoke units also available upon request.

Flexi-Serve is manufactured at our purpose-built factory in Draycott, Derbyshire.

**Flexi-Serve by Parry – The Flexible Servery.**

## The Range

- Hot Cupboard with Plain Top
- Hot Cupboard with Hot Top
- Hot Cupboard with Dry Bain Marie Top
- Ambient Cupboard with Plain Top
- Ambient Cupboard with Chilled Well
- Ambient Cupboard with Refrigerated Well
- Till Section Left
- Till Section Right
- Corner Section
- Corner Section Open Storage
- Corner Section Square



Low level  
version available  
800mm

## Key Benefits

- Flexible** - Design the layout to suit your space, service needs, customer flow and capacity requirements
- Modular** - A variety of module types and sizes - heated, ambient, chilled & accompanying sections
- Adaptable** - Choose the modules which best suit your menu & operational needs
- Compatible** - Work with a range of gastronorm sizes
- Accessories** - Heated or illuminated gantries, tray slides, menu boards, interchangeable panels and more
- Versatile** - Use individually or suite multiple units to form a fixed counter
- Efficient** - All units run on a single 13amp plug for reduced power consumption and convenience
- Bespoke** - Range of finishes including steel, laminate or custom wrapped panels to suit your style and branding



## WARRANTY POLICY

The manufacturer's warranty is only valid in the UK mainland Northern Ireland, Western Isles, Inner Hebrides and Islands are parts only warranty. Please be aware that the warranty starts from the date of purchase from Parry and not the sale or installation date of the equipment.

To be eligible for a 2 year warranty, products must be serviced at least once within the first 12 months of purchase.

All service calls will be carried out between 8am and 5pm, Monday to Friday.

Your warranty is invalid if your equipment has not been installed in accordance with the manufacturer's instructions. The misuse, alteration or unauthorised repairs of the equipment will also invalidate the warranty.

During the warranty period it is at Parry's discretion whether to repair or replace the equipment.

The warranty only applies if the equipment has been used in a professional manner following the manufacturer's instructions and maintenance guidelines.

The warranty covers defects in the material and component failure only. We are not liable for trading loss, loss of perishable items, water damage or loss due to injury or fire damage.

Please ensure you have referred to the manufacturer's instruction before placing a warranty call.

Contact our warranty department on **01332 87544** for technical assistance.

Please have your model number ready before calling.

All warranty requests must be submitted to **warranty@parry.co.uk**.

Failure to pay any warranty charges will result in your warranty being put on hold until the bill has been settled. Any issues regarding the raised charges should be put in writing to our warranty department for further investigation.

Register your product by visiting our website **www.parry.co.uk**

## NOT COVERED UNDER WARRANTY

- Fault due to incorrect installation, poor maintenance or equipment abuse.
- Resetting of equipment or circuit breakers.
- Faulty electrics – e.g. customer's plug socket, plug, wiring, junction box fault, wrong fuse.
- Products must be serviced within the first 12 months to be eligible for the 2 year warranty.
- Product not covered by warranty if combustible materials have been used, e.g. plastic trays.
- Foil used on racks, blockages and lime scale issues. Failure to grant access for pre-arranged service call. Equipment that has been set up or used incorrectly e.g. dishwasher detergents, levelling and setting up of doors on a six burner cooker.
- Excessive carbon build-up on griddle plates or overuse of lava rock on charrills. (Recommended use by Parry no more than 2kg.)
- Appliances that have been installed in mobile trailers are covered by parts only warranty for 24 months.
- Extraction canopies are sold with parts only warranty on the fans and speed controllers for 24 months. If parts are found to be faulty through lack of cleaning of the extraction canopy the part will be chargeable. The equipment should be installed by a competent person. The equipment installer needs to know the design, performance and the capacity of the ventilation system, so they can ensure adequate ventilation.
- All of the above points are not covered by warranty and any costs incurred, because of the above, will be forwarded to the parties responsible for placing the call.





## RETURNS POLICY

---

### RETURNS PROCESS

As per section 11 of our Terms and Conditions, all items that are returned MUST be authorised prior by calling our Sales office. You will be provided with a returns authorisation number which will need to be recorded on the outside of the return package. Any goods returned without the visible returns number will not be accepted and will be returned with your courier.

### GOODS NO LONGER REQUIRED

Please note we will not accept goods back that have been purchased more than 48hrs from the date of invoice. The customer will be required to return the goods at their own cost and these must be returned back to us in the original packaging and in A1 condition. The goods will be subject to a handling charge of 25%. If however the goods arrive back to us damaged then a credit will not be raised and the goods will remain the property of the customer and will need to be collected from Parry.

### GOODS ORDERED IN ERROR

Please note we will not accept goods back that have been purchased more than 48hrs from the date of invoice. The customer will be required to return the goods at their own cost and these must be returned back to us in the original packaging and in A1 condition. The goods will be subject to a handling charge of 25%. If however the goods arrive back to us damaged then a credit will not be raised and the goods will remain the property of the customer and will need to be collected from Parry.

### GOODS DAMAGED IN TRANSIT

All claims for damages must be reported within 24 hours of delivery to enable us to make a claim, any reported after this time cannot be replaced so please check the POD if necessary.

### FAULTY GOODS

Customers should call our Sales team on **01332 875544** at the time an item is discovered to be faulty to speak to our warranty team.



# PARRY TERMS AND CONDITIONS

The Buyer's attention is in particular drawn to the provisions of Condition 13.

## 1. INTERPRETATION

- 1.1. The definitions and rules of interpretation in this condition apply in these Conditions

**Buyer:** the person, firm or company who purchases the Goods from the Company;

**Company:** Parry Catering Equipment (Midlands) Ltd, Registered number 10439825 Registered Address: Sapphire Heights Courtyard, 31 Tenby Street North, Birmingham B1 3ES

**Contract:** any contract between the Company and the Buyer for the sale and purchase of the Goods, incorporating these Conditions;

**Delivery Point:** the place where delivery of the Goods is to take place under Condition 4;

**Goods:** any goods agreed in the Contract to be supplied to the Buyer by the Company (including any part or parts of them).

- 1.2. A reference to a particular law is a reference to it as it is in force for the time being taking account of any amendment, extension, application or re-enactment and includes any subordinate legislation for the time being in force made under it.
- 1.3. Words in the singular include the plural and in the plural include the singular.
- 1.4. A reference to one gender includes a reference to the other gender.
- 1.5. Condition headings do not affect the interpretation of these Conditions.

## 2. APPLICATION OF TERMS

- 2.1. Subject to any variation under Condition 2.3 the Contract shall be on these Conditions to the exclusion of all other terms and conditions (including any terms or conditions which the Buyer purports to apply under any purchase order, confirmation of order, specification or other document).
- 2.2. No terms or conditions endorsed on, delivered with or contained in the Buyer's purchase order, confirmation of order, specification or other document shall form part of the Contract simply as a result of such document being referred to in the Contract.
- 2.3. These Conditions apply to all the Company's sales and any variation to these Conditions and any representations about the Goods shall have no effect unless expressly agreed in writing and signed by a director of the Company. The Buyer acknowledges that it has not relied on any statement, promise or representation made or given by or on behalf of the Company which is not set out in the Contract. Nothing in this Condition shall exclude or limit the Company's liability for fraudulent misrepresentation.
- 2.4. Each order or acceptance of a quotation for Goods by the Buyer from the Company shall be deemed to be an offer by the Buyer to buy Goods subject to these Conditions.
- 2.5. No order placed by the Buyer shall be deemed to be accepted by the Company until a written acknowledgement of order is issued by the Company or (if earlier) the Company delivers the Goods to the Buyer.
- 2.6. The Buyer shall ensure that the terms of its order and any applicable specification are complete and accurate.
- 2.7. Any quotation is given on the basis that no Contract shall come into existence until the Company despatches an acknowledgement of order to the Buyer. Any quotation is valid for a period of 30 days only from its date, provided that the Company has not previously withdrawn it.

## 3. DESCRIPTION

- 3.1. The quantity and description of the Goods shall be as set out in the Company's quotation or acknowledgement of order.
- 3.2. All samples, drawings, descriptive matter, specifications and advertising issued by the

Company and any descriptions or illustrations contained in the Company's catalogues or brochures are issued or published for the sole purpose of giving an approximate idea of the Goods described in them and shall remain the property of the Company (together with the copyright therein). They shall not form part of the Contract and this is not a sale by sample.

## 4. DELIVERY

- 4.1. Unless otherwise agreed in writing by the Company, delivery of the Goods shall take place at the Buyer's place of business.
- 4.2. The Company reserves the right to charge for carriage and packaging at its discretion.
- 4.3. When the Goods are delivered to the Buyer, the Buyer must ensure that each consignment note is countersigned by one of the Buyer's employees or agents showing the time and date of arrival of the Goods. Clear signatures should be given on each consignment note and such counter signature(s) shall mean that the Buyer has accepted delivery of the Goods. The Company cannot accept responsibility for indecipherable signatures should the consignment become the subject of a claim
- 4.4. The Company must be notified within 24 hours of the time of arrival of the Goods of any claim for damage, whereupon the following details must be notified to the Company: advice note number; time and date of arrival of the Goods; name of carrier; condition of Goods and packaging; and date the carrier advised.
- 4.5. The provisions of S35 (A) of The Sale of Goods Act 1979 (as amended) shall not apply to the Contract except where the Buyer deals as a consumer within the meaning of Section 12 of the Unfair Contract Terms Act 1977.
- 4.6. Any dates specified by the Company for delivery of the Goods are intended to be an estimate and time for delivery shall not be made of the essence by notice. If no dates are so specified, delivery shall be within a reasonable time.
- 4.7. Subject to the other provisions of these Conditions the Company shall not be liable for any direct, indirect or consequential loss (all three of which terms include, without limitation, pure economic loss, loss of profits, loss of business, depletion of goodwill and similar loss), costs, damages, charges or expenses caused directly or indirectly by any delay in the delivery of the Goods (even if caused by the Company's negligence), nor shall any delay entitle the Buyer to terminate or rescind the Contract unless such delay exceeds 180 days.
- 4.8. If for any reason the Buyer fails to accept delivery of any of the Goods when they are ready for delivery, or the Company is unable to deliver the Goods on time because the Buyer has not provided appropriate instructions, documents, licences or authorisations:
- 4.8.1. risk in the Goods shall pass to the Buyer (including for loss or damage caused by the Company's negligence);
- 4.8.2. the Goods shall be deemed to have been delivered; and
- 4.8.3. The Company may store the Goods until delivery, whereupon the Buyer shall be liable for all related costs and expenses (including, without limitation, storage and insurance).
- 4.9. The Buyer shall provide at the Delivery Point and at its expense adequate and appropriate equipment and manual labour for loading or unloading (as the case may be) the Goods.
- 4.10. The Company may deliver the Goods by separate instalments. Each separate instalment shall be invoiced and paid for in accordance with the provisions of the Contract.
- 4.11. Each instalment shall be a separate Contract and no cancellation or termination of any one Contract relating to an instalment shall entitle the Buyer to repudiate or cancel any other Contract or instalment.

## 5. NON-DELIVERY

- 5.1. The quantity of any consignment of Goods as recorded by the Company on despatch from the Company's place of business shall be conclusive evidence of the quantity received by the Buyer on delivery unless the Buyer can provide conclusive evidence proving the contrary.
- 5.2. The Company shall not be liable for any non-delivery of Goods (even if caused by the Company's negligence) unless the Buyer gives written notice to the Company of the non-delivery within 5 days of the date when the Goods would in the ordinary course of events have been received.
- 5.3. Any liability of the Company for non-delivery of the Goods shall be limited to replacing the Goods within a reasonable time or issuing a credit note at the pro rata Contract rate against any invoice raised for such Goods.

## 6. RISK/TITLE

- 6.1. The Goods are at the risk of the Buyer from the time of delivery.
- 6.2. Ownership of the Goods shall not pass to the Buyer until the Company has received in full (in cash or cleared funds) all sums due to it in respect of:
- 6.2.1. the Goods; and
- 6.2.2. All other sums which are or which become due to the Company from the Buyer on any account.
- 6.3. Until ownership of the Goods has passed to the Buyer, the Buyer shall:
- 6.3.1. hold the Goods on a fiduciary basis as the Company's bailee;
- 6.3.2. store the Goods (at no cost to the Company) separately from all other goods of the Buyer or any third party in such a way that they remain readily identifiable as the Company's property;
- 6.3.3. not destroy, deface or obscure any identifying mark or packaging on or relating to the Goods; and
- 6.3.4. Maintain the Goods in satisfactory condition and keep them insured on the Company's behalf for their full price against all risks to the reasonable satisfaction of the Company. On request the Buyer shall produce the policy of insurance to the Company.
- 6.4. The Buyer may resell the Goods before ownership has passed to it solely on the following conditions:
- 6.4.1. any sale shall be effected in the ordinary course of the Buyer's business at full market value; and
- 6.4.2. Any such sale shall be a sale of the Company's property on the Buyer's own behalf and the Buyer shall deal as principal when making such a sale.
- 6.5. The Buyer's right to possession of the Goods shall terminate immediately if:
- 6.5.1. the Buyer has a bankruptcy order made against him or makes an arrangement or composition with his creditors, or otherwise takes the benefit of any statutory provision for the time being in force for the relief of insolvent debtors, or (being a body corporate) convenes a meeting of creditors (whether formal or informal), or enters into liquidation (whether voluntary or compulsory) except a solvent voluntary liquidation for the purpose only of reconstruction or amalgamation, or has a receiver and/or manager, administrator or administrative receiver appointed of its undertaking or any part thereof, or documents are filed with the court for the appointment of an administrator of the Buyer or notice of intention to appoint an administrator is given by the Buyer or its directors or by a qualifying floating charge holder (as defined in paragraph 14 of Schedule B1 to the Insolvency

- Act 1986), or a resolution is passed or a petition presented to any court for the winding-up of the Buyer or for the granting of an administration order in respect of the Buyer, or any proceedings are commenced relating to the insolvency or possible insolvency of the Buyer; or
- 6.5.2. the Buyer suffers or allows any execution, whether legal or equitable, to be levied on his/its property or obtained against him/it, or fails to observe or perform any of his/its obligations under the Contract or any other contract between the Company and the Buyer, or is unable to pay its debts within the meaning of section 123 of the Insolvency Act 1986 or the Buyer ceases to trade; or
- 6.5.3. The Buyer encumbers or in any way charges any of the Goods.
- 6.6. The Company shall be entitled to recover payment for the Goods notwithstanding that ownership of any of the Goods has not passed from the Company.
- 6.7. The Buyer grants the Company, its agents and employees an irrevocable licence at any time to enter any premises where the Goods are or may be stored in order to inspect them, or, where the Buyer's right to possession has terminated, to recover them.
- 6.8. Where the Company is unable to determine whether any Goods are the Goods in respect of which the Buyer's right to possession has terminated, the Buyer shall be deemed to have sold all Goods of the kind sold by the Company to the Buyer in the order in which they were invoiced to the Buyer.
- 6.9. On termination of the Contract, howsoever caused, the Company's (but not the Buyer's) rights contained in this Condition 6 shall remain in effect.
- 7. PRICE**
- 7.1. Unless otherwise agreed in writing by the Company, the price for the Goods shall be the price set out in the Company's price list published on the date of delivery or deemed delivery.
- 7.2. The price for the Goods shall be exclusive of any value added tax and all costs or charges in relation to packaging, loading, unloading, carriage and insurance, all of which amounts the Buyer shall pay in addition when it is due to pay for the Goods.
- 8. PAYMENT**
- 8.1. Subject to Condition 8.4, payment of the price for the Goods is due in pounds sterling on the date of delivery or deemed delivery.
- 8.2. Time for payment shall be of the essence.
- 8.3. No payment shall be deemed to have been received until the Company has received cleared funds.
- 8.4. All payments payable to the Company under the Contract shall become due immediately on its termination despite any other provision.
- 8.5. The Buyer shall make all payments due under the Contract in full without any deduction whether by way of set-off, counterclaim, discount, abatement or otherwise unless the Buyer has a valid court order requiring an amount equal to such deduction to be paid by the Company to the Buyer.
- 8.6. If the Buyer fails to pay the Company any sum due pursuant to the Contract, the Buyer shall be liable to pay interest to the Company on such sum from the due date for payment at the annual rate of 2% above the base lending rate from time to time of HSBC Bank Plc, accruing on a daily basis until payment is made, whether before or after any judgment, together with all direct expenses reasonably incurred by the Company in collecting or attempting to collect amounts outstanding, such expenses shall include but shall not be limited to fees of delivery collection services, solicitors, accountants and all other direct expenses so incurred. The Company reserves the right to claim interest under the Late Payment of Commercial Debts (Interest) Act 1998.
- 9. CREDIT**
- The Contract shall be subject to the Company being satisfied as to the Buyer's references and without prejudice to the generality of the foregoing, the Company may (in its absolute discretion), having informed the Buyer that the Goods are ready for despatch, refrain from delivering the Goods until such time as the Buyer tenders payment of the price for the Goods together with any other sums which are or which become due to the Company from the Buyer on any account.
- 10. GUARANTEE**
- 10.1. Subject to the remaining provisions of this Condition 10, if the Buyer establishes to the Company's reasonable satisfaction that:
- 10.1.1. the Goods are defective or (where applicable) there is a defect in the workmanship of the Goods; or
- 10.1.2. (where applicable) there is a defect in the design of the Goods; or
- 10.1.3. (where applicable) the Goods are not in accordance with the quality or specification contained in the Contract; or
- 10.1.4. there is some other failure on the Company's part in relation to the Goods to comply with the Contract
- Then
- 10.1.5. in the case of all Parry branded Catering Equipment including stainless steel fabricated goods: excluding all gas powered appliances not permanently installed in a static non-combustible structure incorporating concrete or brick foundations in which case the Company's obligation under this condition is limited to the supply of free spare parts only; within a period of 24 months from the date of delivery to a Parry Group Limited Customer. The warranty may be withdrawn if the equipment has not been installed and maintained as per the manufacturer's instructions.
- 10.1.6. In the case of Parry Electrical goods within a period of 12 months from the date of delivery to a Parry Group Limited customer.
- 10.1.7. In the case of Parry Catering Equipment goods branded "Red One" within a period of 12 months from the date of delivery to a Parry Group Limited customer.
- The Company shall:
- 10.1.8. Repair the Goods; or
- 10.1.9. If the sole opinion of the Company, the Goods cannot be repaired, replace the Goods with goods which are in accordance with the Contract.
- 10.2. Condition 10.1 ("the Guarantee") shall not apply unless:
- 10.2.1. in the case of defects which would have been reasonably apparent to the Buyer on reasonable examination of the Goods on delivery, the Buyer gives written notice of the defect to the Company within 14 days of the date of delivery; or
- 10.2.2. in the case of all other defects, the Buyer gives written notice of the defect to the Company within 7 days of the date when the defect becomes apparent;
- 10.3. The Buyer shall give to the Company, the Company's employees and agents safe and unrestricted access to the Buyer's place of business (together with such other facilities and information as the Company may reasonably require) to enable the Company to ascertain or verify the nature and cause of the alleged defect or failure and to carry out the Company's obligations under the Guarantee.
- 10.4. The Company may give the Buyer written notice to immediately stop using of any of the Goods in respect of which the Company have been notified of an alleged defect or failure. If the Buyer fails to comply with that notice the Company shall not be liable to the Buyer under this Condition or otherwise in relation to such Goods. If the Company does not give the Buyer notice, the Company shall not be liable for any damages or losses which the Buyer suffers if such damages or losses are caused by the Buyer's continued use of the Goods after a defect or failure became apparent to the Buyer.
- 10.5. The Company shall not be under an obligation to repair (or replace) the Goods (or any part of them) where the alleged defect or failure results from the Buyer or any third party's incorrect installation or handling, or alteration without the Company's consent, wear and tear, accident, failure to observe the sampling or testing procedures, abnormal or improper conditions of storage or use or any act, neglect or default (including negligence) or results from incorrect specification or other data supplied by the Buyer to the Company.
- 10.6. The Company shall repair the Goods at the Buyer's place of business.
- 10.7. If in the Company's sole opinion the Goods cannot be repaired, the Company shall deliver the replacement goods provided under the Guarantee to the Buyer at the Buyer's place of business. Ownership of the defective Goods shall (if it has vested in the Buyer) re-vest in the Company. The Buyer shall make any such arrangements as may be necessary to remove the defective Goods but the Buyer must not dispose of any of the Goods without the Company's prior written consent.
- 10.8. The provisions of this Condition 10 shall not apply to any replacement goods provided under the Guarantee.
- 10.9. The Guarantee is in place of any other legal remedy which the Buyer has in respect of any alleged defect or failure and:
- 10.9.1. The Company's liability shall in all cases and for all such purposes be limited to the obligations imposed by the Guarantee;
- 10.9.2. Any other condition, warranty, representation or undertaking of the company as to the quality of the goods or their fitness or suitability for any purpose which may be implied by statute, custom of the trade or otherwise is excluded and the provisions of sections 13 to 15 of the sale of goods act 1979 shall not apply to the contract except where the buyer deals as a consumer within the meaning of section 12 unfair contract terms act 1977;
- 10.9.3. The Company shall not be liable to the Buyer in contract, tort or for breach of statutory duty for any loss of profit, loss of business, depletion of goodwill, loss of opportunity, loss of data, loss of use, loss of contracts, loss of expected savings or interruption to the Buyer's business which the Buyer may suffer by reason of any act, omission, neglect or default (including negligence) in the performance of the obligations of this Condition 10.
- 10.9.4. The Company shall not be liable for faults in or failure of the Goods due to the Buyer's methods of placing or positioning, or the effects of inclement weather during placing or positioning;
- 10.9.4.1. if a defect in the Goods should have been revealed by the Buyer's examination at the time of supply, the Company's responsibility in respect of such defect shall be limited to the supply of goods to replace the defective goods;
- 10.9.4.2. if at the Buyer's request the Company have incorporated any additional material from any source into the Goods supplied the Company shall not have any liability for any losses that may be suffered by the Buyer in respect of such incorporation;
- 10.9.5. Without prejudice to the above where in relation to any supply of Goods the Company comply with the Buyer's request for a variation of any of the constituents and/or properties referred to in the description of the Goods specified on the consignment note, the Buyer accepts

any consequential variation to those constituents and/or properties and the Company shall have no liability for any loss, damage or defect resulting from such variation or additions.

10.9.6. The Company shall not be liable for any additional costs incurred accessing the goods with an alleged failure or defect, as a placement or positioning the Goods by the Buyer.

#### 11. RETURN OF GOODS

In no circumstances may Goods supplied against an accepted order be returned by the Buyer without the Buyer having first applied for and obtained the written consent of the Company. A handling charge may be deducted from any credit allowed where it is established to the Company's reasonable satisfaction that the reason for the return of the Goods was the subject of Condition 4.4 (Damage in Transit) and Clause 10 (Guarantee to replace) or through any error on the part of the Company.

#### 12. INSPECTION AND TEST

The Company's products are carefully inspected and where practicable submitted to the Company's standard tests at the Company's place of business before despatch. If tests other than the Company's standard tests are required or tests are required to be carried out in the presence of the Buyer (or the Buyer's representative), the Company reserves the right to charge for such testing. In the event of any delay on the Buyer's part in attending such tests, such delay being longer than 7 days from the date that the Company notified the Buyer that the Company is in a position to proceed, the Company reserves the right to proceed with such tests in the Buyer's absence and such tests shall be deemed to have been made in the Buyer's presence.

#### 13. LIMITATION OF LIABILITY

13.1. Subject to Condition 4, Condition 5 and Condition 10, the following provisions set out the entire financial liability of the Company (including any liability for the acts or omissions of its employees, agents and sub-contractors) to the Buyer in respect of:

13.1.1. any breach of these Conditions;

13.1.2. any use made or resale by the Buyer of any of the Goods, or of any product incorporating any of the Goods; and

13.1.3. Any representation, statement or tortious act or omission including negligence arising under or in connection with the Contract.

13.2. Nothing in these Conditions shall impose on the Company any liability in respect of any representation, suggestion or comment with regard to the Goods made by the Company, its employees or agents in the course of any negotiations between the Company and the Buyer (including but not limited to any performance figures given by the Company) leading to the making of the Contract unless in the case of any such representation the Company has expressly agreed in writing that it shall be a term of the Contract. Nothing in this Condition shall exclude or limit the Company's liability for fraudulent misrepresentation.

13.3. All warranties, conditions and other terms implied by statute or common law (save for the conditions implied by section 12 of the Sale of Goods Act 1979) are, to the fullest extent permitted by law, excluded from the Contract.

13.4. Nothing in these Conditions excludes or limits the liability of the Company:

13.4.1. for death or personal injury caused by the Company's negligence; or

13.4.2. under section 2(3), Consumer Protection Act 1987; or

13.4.3. for any matter which it would be illegal for the Company to exclude or attempt to exclude its liability; or

13.4.4. For fraud or fraudulent misrepresentation.

13.5. Subject to Condition 13.3 and Condition 13.4:

13.5.1. the Company's total liability in contract, tort (including negligence or breach of statutory duty), misrepresentation, restitution or otherwise, arising in

connection with the performance or contemplated performance of the Contract shall be limited to the Contract price; and

13.5.2. the Company shall not be liable to the Buyer for any pure economic loss, loss of profit, loss of business, depletion of goodwill, loss of opportunity, loss of data, loss of use, loss of contracts, loss of expected savings or interruption to the Buyer's business, in each case whether direct, indirect or consequential, or any claims for consequential compensation whatsoever (howsoever caused) which arise out of or in connection with the Contract.

#### 14. ASSIGNMENT

14.1. The Company may assign the Contract or any part of it to any person, firm or company.

14.2. The Buyer shall not be entitled to assign the Contract or any part of it without the prior written consent of the Company.

#### 15. FORCE MAJEURE

The Company reserves the right to defer the date of delivery or to cancel the Contract or reduce the volume of the Goods ordered by the Buyer (without liability to the Buyer) if it is prevented from or delayed in the carrying on of its business due to circumstances beyond the reasonable control of the Company including, without limitation, acts of God, governmental actions, war or national emergency, acts of terrorism, protests, riot, civil commotion, fire, explosion, flood, epidemic, lock-outs, strikes or other labour disputes (whether or not relating to either party's workforce), or restraints or delays affecting carriers or inability or delay in obtaining supplies of adequate or suitable materials.

#### 16. EXPORT TERMS

16.1. Unless otherwise agreed in writing by the Company, where the Goods are supplied for export from the United Kingdom the Buyer shall be responsible (at the Buyer's cost) for complying with any legislation or regulations governing the importation of the Goods into the country of destination (including obtaining relevant licences, permits and permissions) and for the payment of any duties and for supplying all relevant details to the Company where delivery is to be made at the Buyer's place of business.

16.2. Unless the Buyer is to collect the Goods from the Company's place of business the Goods shall be delivered at the Buyer's nominated place of business (as agreed by the Company).

#### 17. GENERAL

17.1. Each right or remedy of the Company under the Contract is without prejudice to any other right or remedy of the Company whether under the Contract or not.

17.2. If any provision of the Contract is found by any court, tribunal or administrative body of competent jurisdiction to be wholly or partly illegal, invalid, void, voidable, unenforceable or unreasonable it shall to the extent of such illegality, invalidity, voidness, voidability, unenforceability or unreasonableness be deemed severable and the remaining provisions of the Contract and the remainder of such provision shall continue in full force and effect.

17.3. Failure or delay by the Company in enforcing or partially enforcing any provision of the Contract shall not be construed as a waiver of any of its rights under the Contract.

17.4. Any waiver by the Company of any breach of, or any default under, any provision of the Contract by the Buyer shall not be deemed a waiver of any subsequent breach or default and shall in no way affect the other terms of the Contract.

17.5. The parties to the Contract do not intend that any term of the Contract shall be enforceable by virtue of the Contracts (Rights of Third Parties) Act 1999 by any person that is not a party to it.

17.6. The formation, existence, construction, performance, validity and all aspects of the Contract shall be governed by English law and the parties submit to the exclusive jurisdiction of the English courts.

#### 18. COMMUNICATIONS

18.1. All communications between the parties about the Contract shall be in writing and delivered by hand or sent by pre-paid first class post or sent

by fax:

18.1.1. (in case of communications to the Company) to its registered office or such changed address as shall be notified to the Buyer by the Company; or

18.1.2. (in the case of the communications to the Buyer) to the registered office of the addressee (if it is a company) or (in any other case) to any address of the Buyer set out in any document which forms part of the Contract or such other address as shall be notified to the Company by the Buyer.

18.2. Communications shall be deemed to have been received:

18.2.1. if sent by pre-paid first class post, two days (excluding Saturdays, Sundays and bank and public holidays) after posting (exclusive of the day of posting); or

18.2.2. if delivered by hand, on the day of delivery; or

18.2.3. If sent by fax on a working day prior to 4.00 pm, at the time of transmission and otherwise on the next working day.

#### Appendix 1

Parry Catering Equipment Alpha Range, Paragon Range and Parry Plus Range with the exception of products listed in clause 10.1.7.

#### PARRY CATERING EQUIPMENT (MIDLANDS) LTD Conditions of Sale for Fabrications

##### STANDARD FABRICATIONS:

- (1) Cancellation of Purchase Orders on Standard Fabrications:-
  - (a) Purchase Orders (P/Os) may be cancelled at any time before the Order Acknowledgement (O/A) has been issued without incurring any cost.
  - (b) P/Os that are cancelled after the O/A has been issued will be subject to a charge of 25% of the P/O value.
  - (c) P/Os that have one item cancelled after the O/A has been issued will be subject to a charge of 25% of the value of the cancelled item, or £75, whichever value is greater.
- (2) Alterations to Purchase Orders on Standard Fabrications:-
  - (a) P/Os may be altered to another similar standard fabrication product or a similar bespoke fabrication product after the O/A has been issued without incurring any cost.

##### BESPOKE FABRICATIONS:

- (3) Cancellation of Purchase Orders on Bespoke Fabrications:-
  - (a) P/Os may be cancelled at any time before the O/A has been issued without incurring any cost.
  - (b) P/Os may be cancelled up to 24 hours after the O/A has been issued without incurring any cost.
  - (c) P/Os that are cancelled after 24 hours from the time of issue of the O/A will be subject to a charge of 100% of the P/O value.
  - (d) P/Os that have one item cancelled after 24 hours from the time of issue of the O/A will be subject to a charge of 100% of the cancelled item.
- (4) Alterations to Purchase Orders on Bespoke Fabrications:-
  - (a) P/Os may be altered up to 24 hours from the issue of the O/A without incurring any cost.
  - (b) P/Os that are altered after 24 hours from the issue of the O/A will be subject to a charge of 100% of the P/O value.
  - (c) P/Os that have an item altered after 24 hours from the issue of the O/A will be subject to a charge of 100% of the altered item.



# References

Please find a range of useful information that will help you when purchasing your Parry Products.

## Gastronorm Pan Sizes



## Conversion Tables

Volume - Imperial to Metric	
1 fluid ounce	= 28.41 millilitres
1 pint	= 568.26 millilitres
1 pint	= 0.568 litres
1 gallon	= 4.546 litres
1 barrel	= 163.66 litres

Temperature - Fahrenheit to Celsius	
100 °F	= 37 °C
150 °F	= 65 °C
200 °F	= 93 °C
250 °F	= 121 °C
300 °F	= 150 °C
350 °F	= 180 °C
400 °F	= 200 °C
450 °F	= 230 °C

Dimensions - Imperial to Metric	
1 inch	= 2.54 centimetres
1 foot	= 30.49 centimetres
1 yard	= 91.44 centimetres
1 yard	= 0.914 metres
1 mile	= 1609.3 metres
1 mile	= 1.609 kilometres

BTU to KW - Conversion	
1 KW	= 3,412 BTU/h
1 BTU/h	= 0.0002930 kW

Gas Supply Pressures	
LPG (Propane)	= 37mb
Natural Gas	= 20mb



Select your quality stainless steel catering equipment, furniture and bespoke fabrications at **parry.co.uk** or on **01332 875 544**

Can't find precisely what you're looking for? Get in touch with your bespoke requirements and we'll go out of our way to exceed your expectations.

Whatever you need, we'd love to help.



Parry Catering Equipment (Midlands) Ltd  
**Sales Tel:** 01332 875544 **Fax:** 01332 874455  
Town End Road, Draycott, Derby, DE72 3PT

[www.parry.co.uk](http://www.parry.co.uk)